

# Comprehensive Plan Process

A comprehensive plan is a map of long-range improvements and changes.

It includes information about the park's current conditions and envisions the changes that are possible for a park. The plan also details how the public is included in the process and illustrates the steps taken towards a final plan for the future of the park.

## Schedule

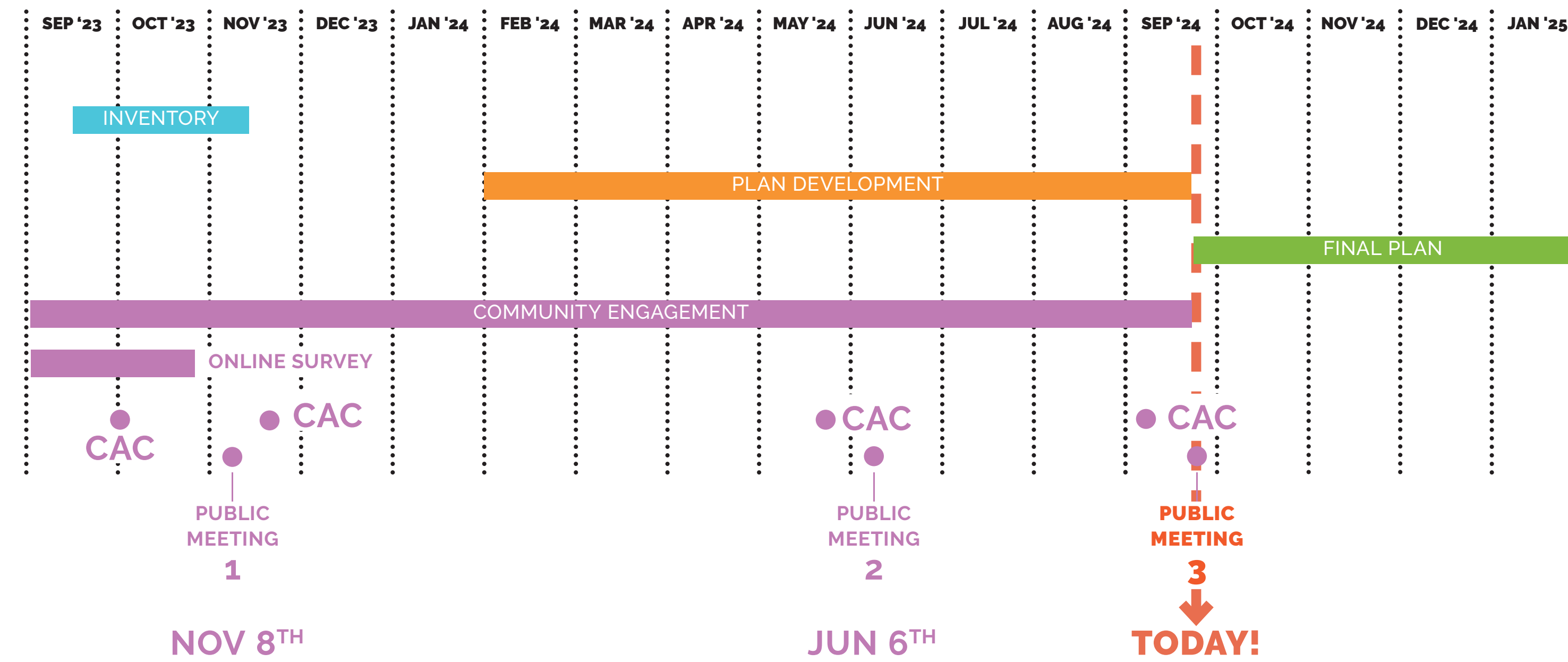

## Stay Informed!

Want to find out more about Roosevelt Park's new comprehensive plan and keep up with the latest news?

Scan this QR code!



## Online Survey #1 Results

From September through October 2023, the public was invited to voice what works, doesn't work, or is missing from the park in an online survey.

### PRIORITIZE WHAT IS NEEDED IN THE PARK (NON-SPORT)

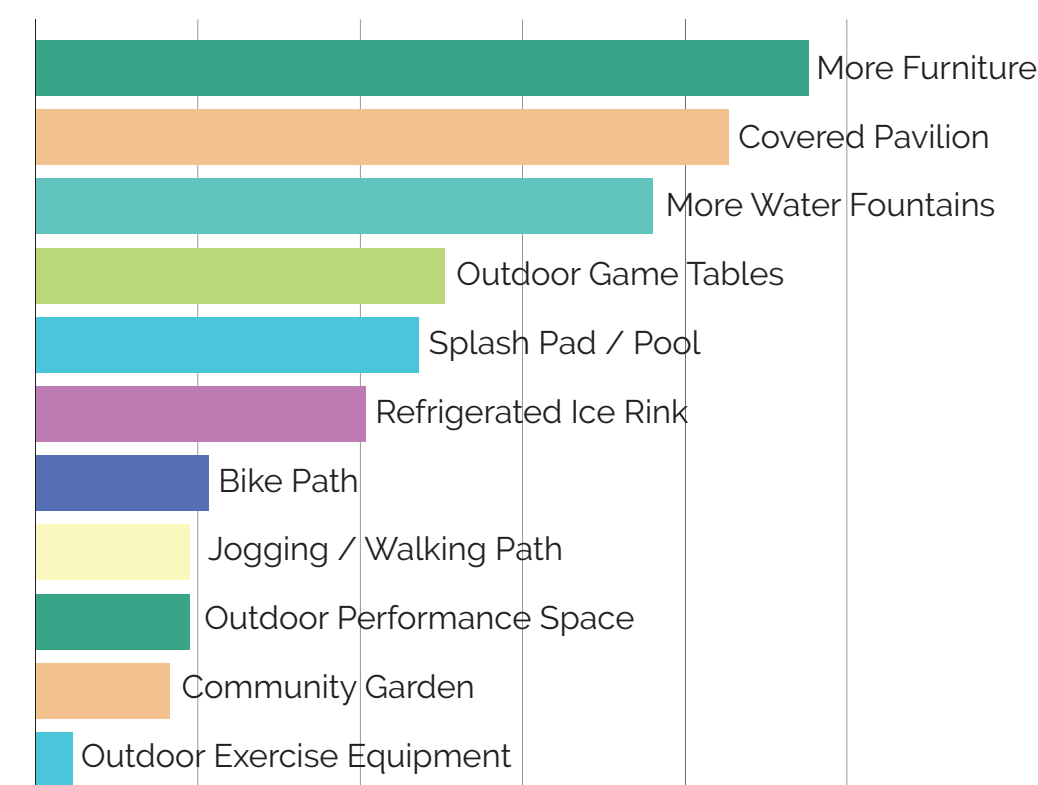

Here are the highlights:

**Non-Sports:** More comfort! Top responses included seating, shade, and drinking fountains.

**Organized Sports:** Most people play/watch Soccer and Little League, Tennis and Basketball.

### WHAT SPORTS DOES YOUR FAMILY PLAY OR WATCH IN THE PARK?

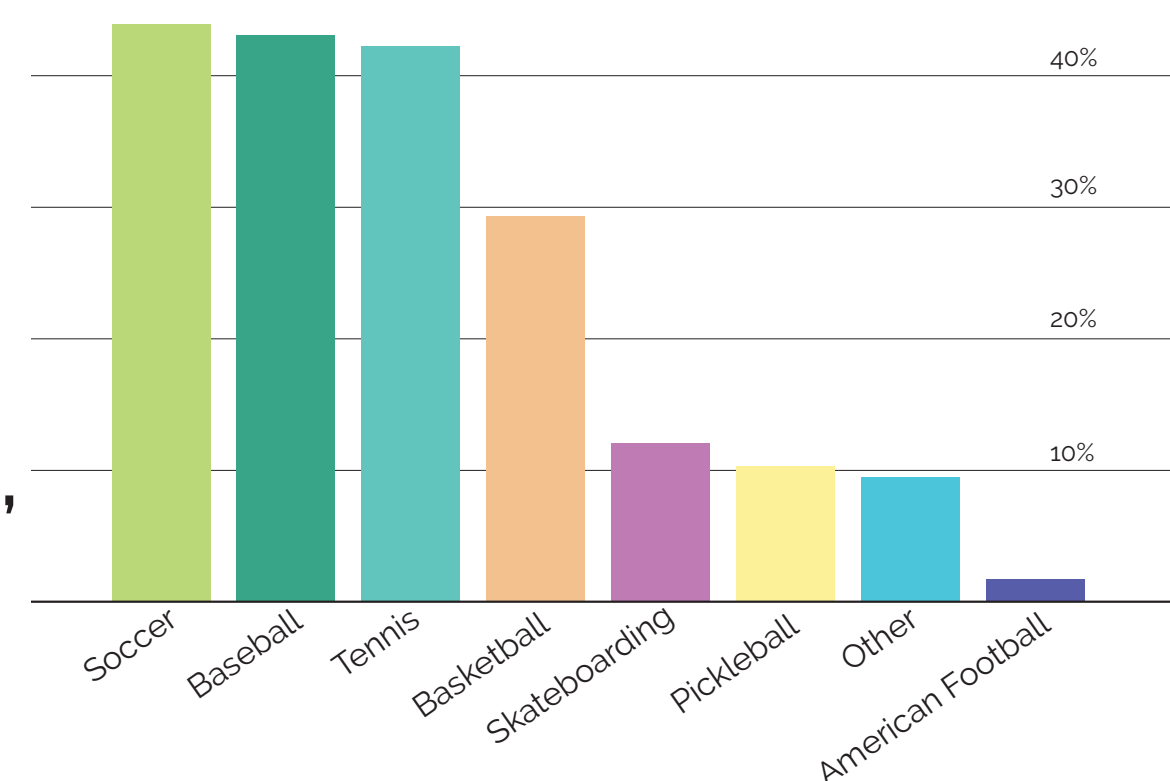

## Stakeholder Interviews

### Stakeholder Interviews: Some of what we heard:

February - May 2024, City Staff met with key stakeholder groups who have a vested interest in the park's development plans.

The City interviewed: Boys and Girls' Club, Richard Kemp Center, VT Racial Alliance, AALV, Trusted Community Voices, Integrated Art Academy, Burlington Children's School

- Dogs are a major problem (off leash + dog waste)
- Better restroom access is needed
- Lighting, shade & seating are lacking
- Splash pad or pool would be loved
- Safety concerns and perceptions
- Covered gathering space is needed
- Fencing is desired by school leaders

### Community Advisory Committee:

Members of the Community Advisory Committee (CAC) are O.N.E. neighbors who attend periodic meetings with the design team and city staff to provide input on the design process and outcomes.



## Public Meeting #1

On November 8, 2023, a public meeting was held to ask residents about their priorities in the park. Here's a quick summary of the engagement activities:



### What are your priorities?

- Soccer Field is the highest priority
- Baseball Field, Roller Skating Rink and Skate Park are in demand too!

### Design Your Park Takeaways

- Keep what's there - it's working!
- Courts and fields can be used for more than one activity!

### RANK YOUR PRIORITIES (STICKER EXERCISE)

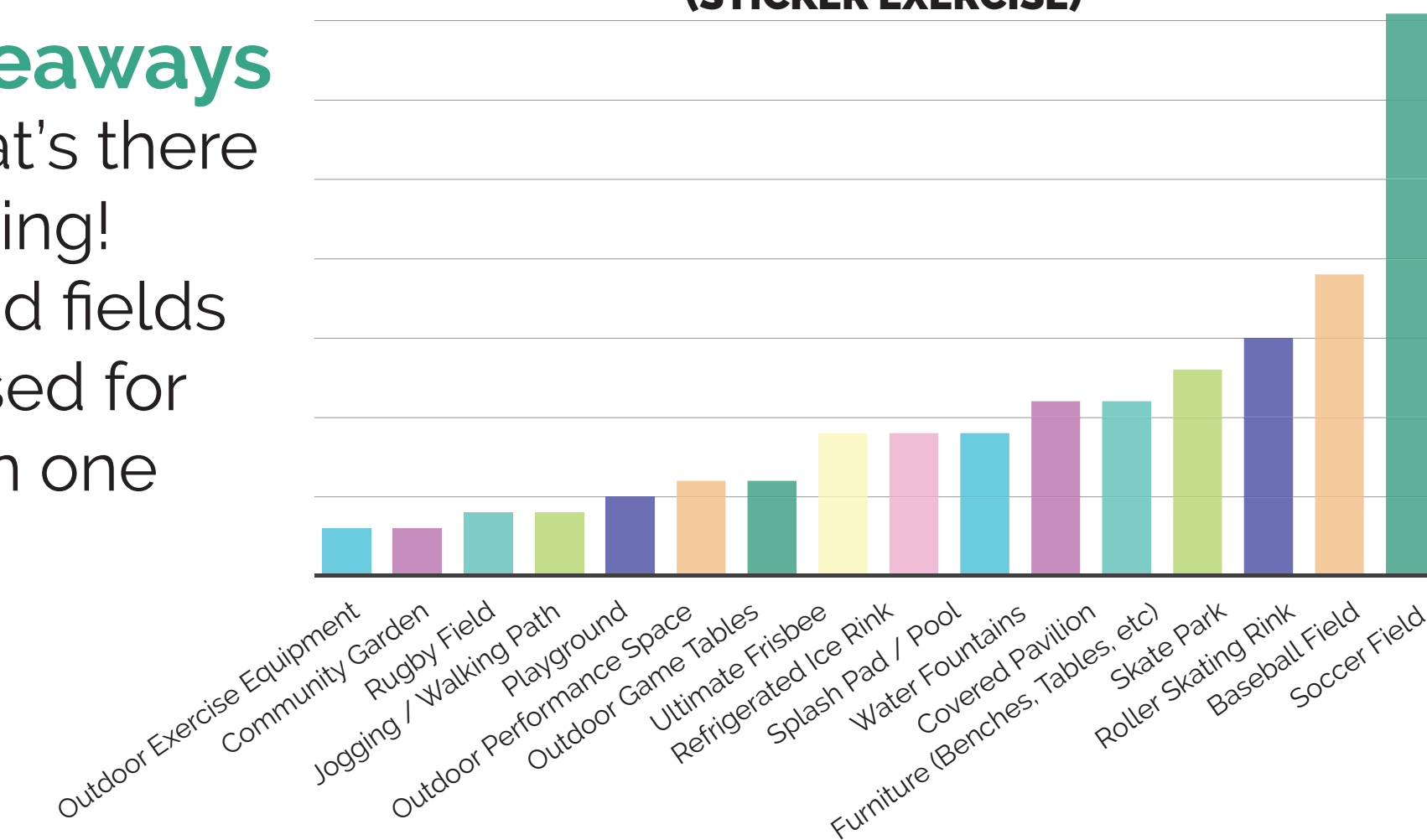

September 24, 2024



VIEWSHED

# Alternatives Outreach

Using feedback from Online Survey #1, Public Meeting #1, and Stakeholder Interviews, the design team developed design alternatives for the park. The park was divided into three sections based on existing form and uses: **West Side**, **East Side**, and **Lil' Rosie**. Three design options were drafted for each of these sections.

In the spring and early summer, Public Meeting #2, a meeting with the Boys and Girls Club, and Online Survey #2 asked park users what design ideas they liked for the park. Participants were asked to vote for their favorite design for each section of the park.

## Boys & Girls Club



**When did the meeting happen?**  
Thursday, June 6, 2024,  
from 3:00 - 4:00 PM

**Where was it?**  
Boys & Girls Club Gym

**How many people were there?**  
Approximately 44 participants

## Public Meeting #2



**When did the meeting happen?**  
Thursday, June 6, 2024,  
from 5:00 - 7:00 PM

**Where was it?**  
O.N.E Community Center

**How many people were there?**  
Approximately 55 participants

## Online Survey #2

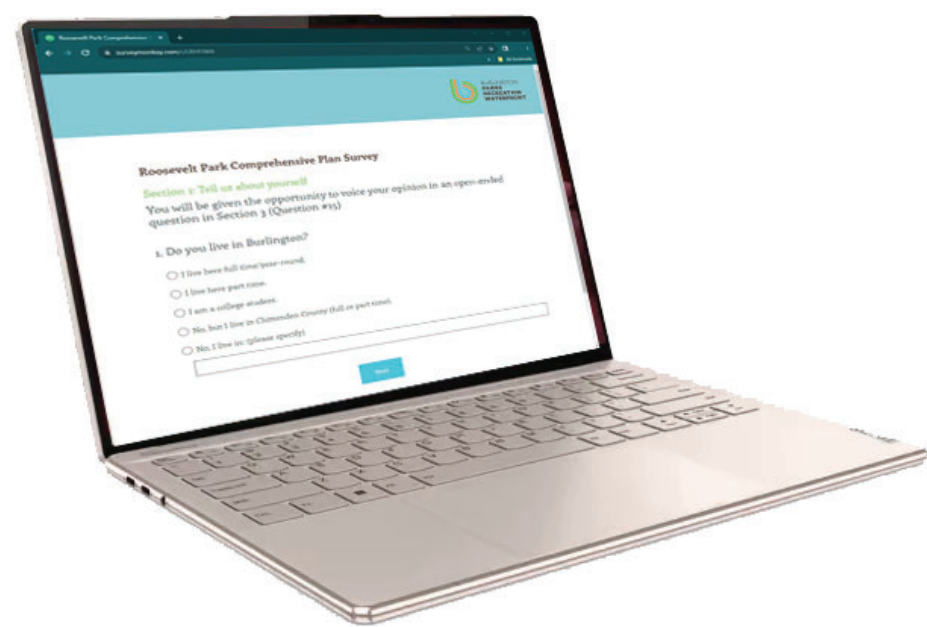

**When was the survey up?**  
June 14 - July 12, 2024.

**Where was the survey posted?**  
Online, accessed through the Roosevelt Comprehensive Plan webpage on the City of Burlington's website

**How many people responded?**  
293 participants

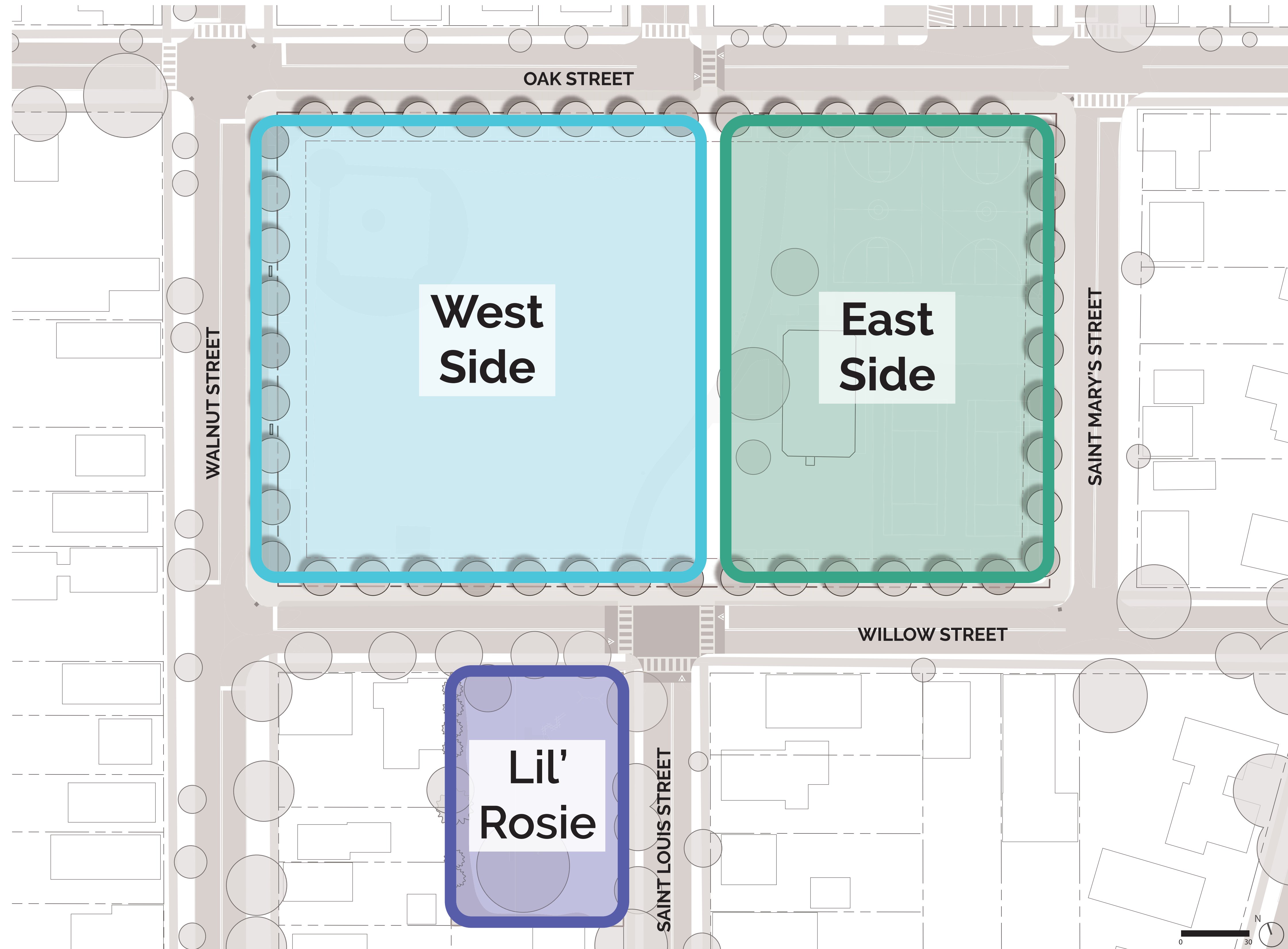

# Alternatives Outreach

## East Side

Key:

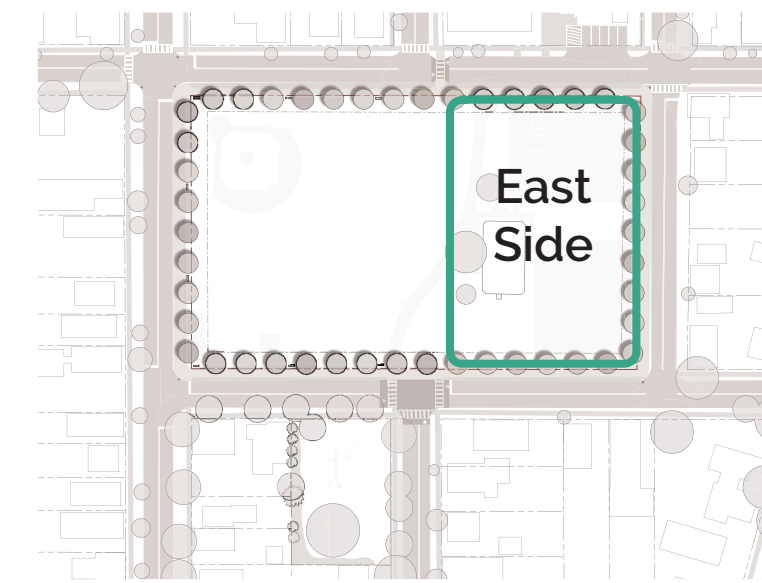

### Option A Made In The Shade



### Option B Take It To The Court

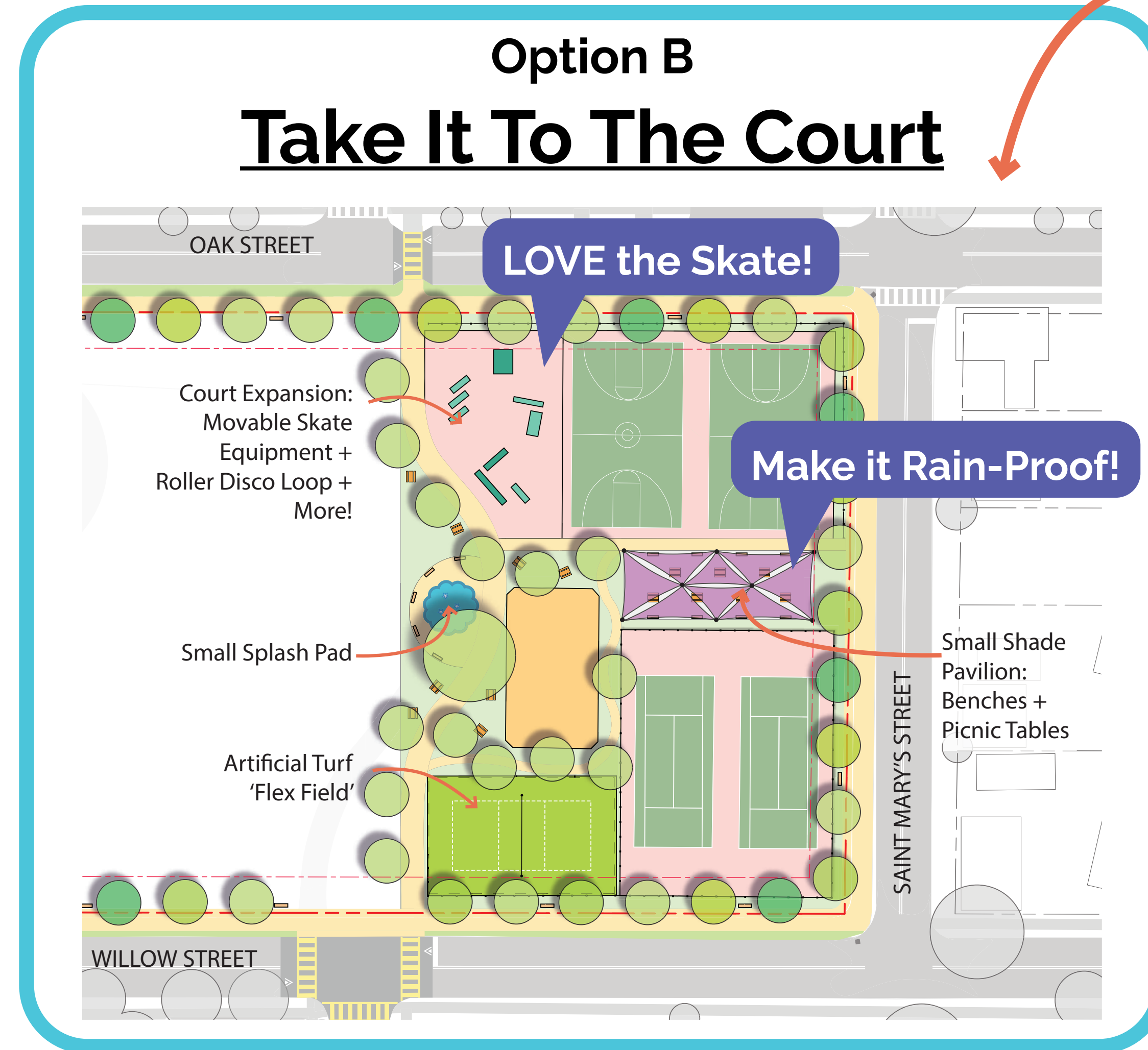

**Winner!**

### Option C Play It Up!



### East Side Individual Votes

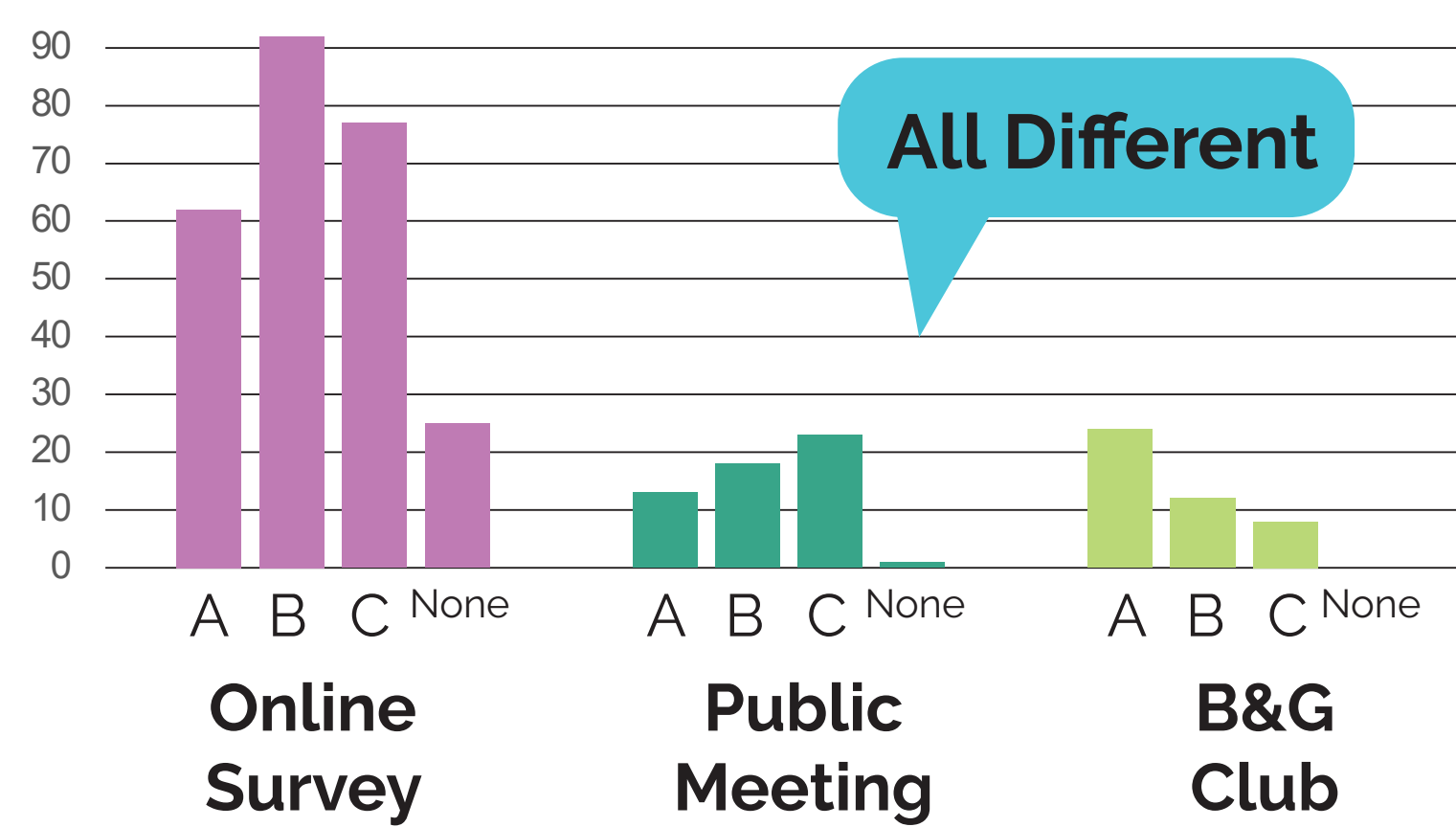

### East Side Total Votes

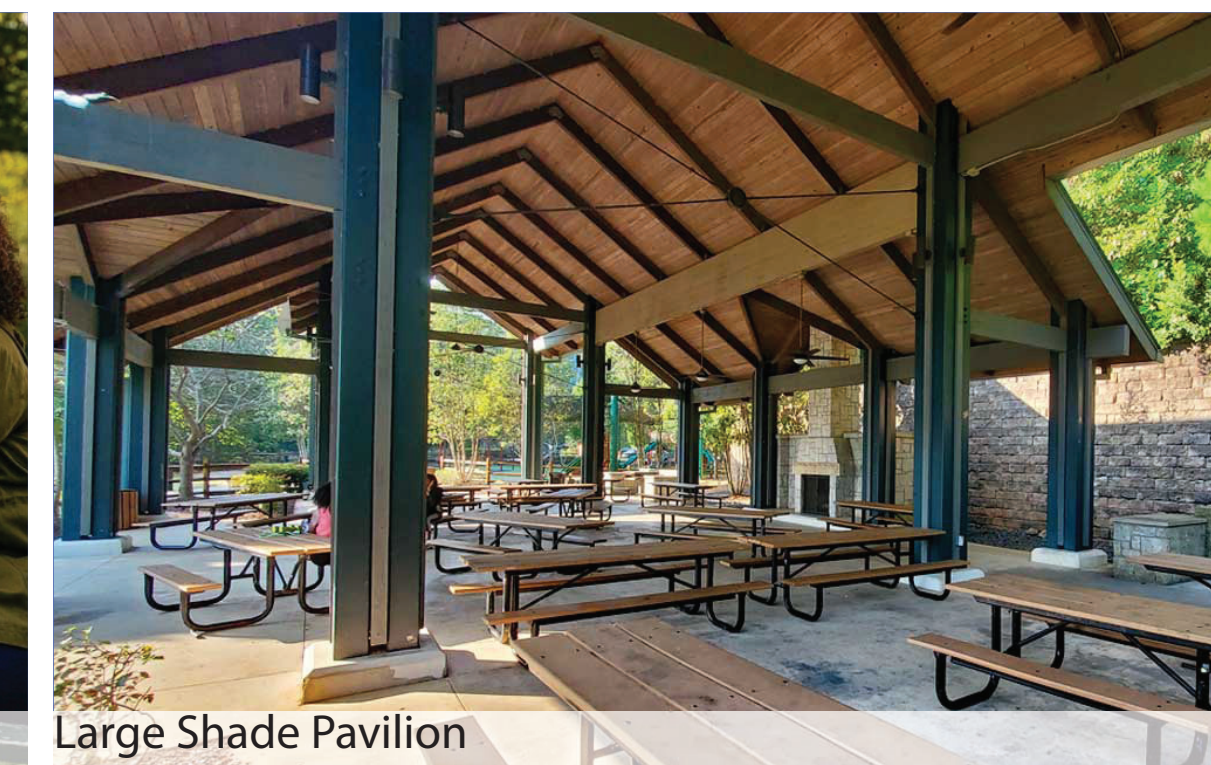
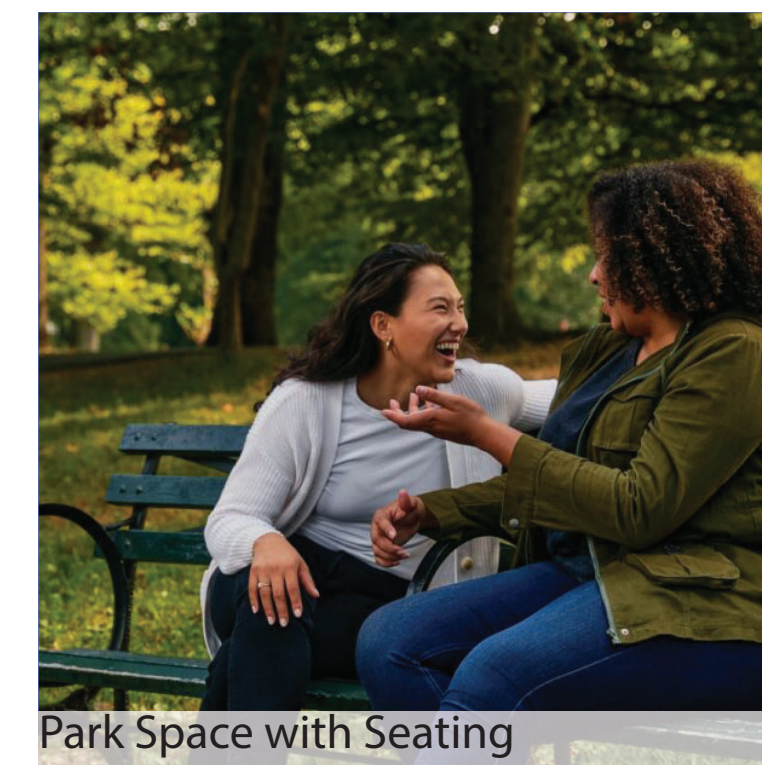
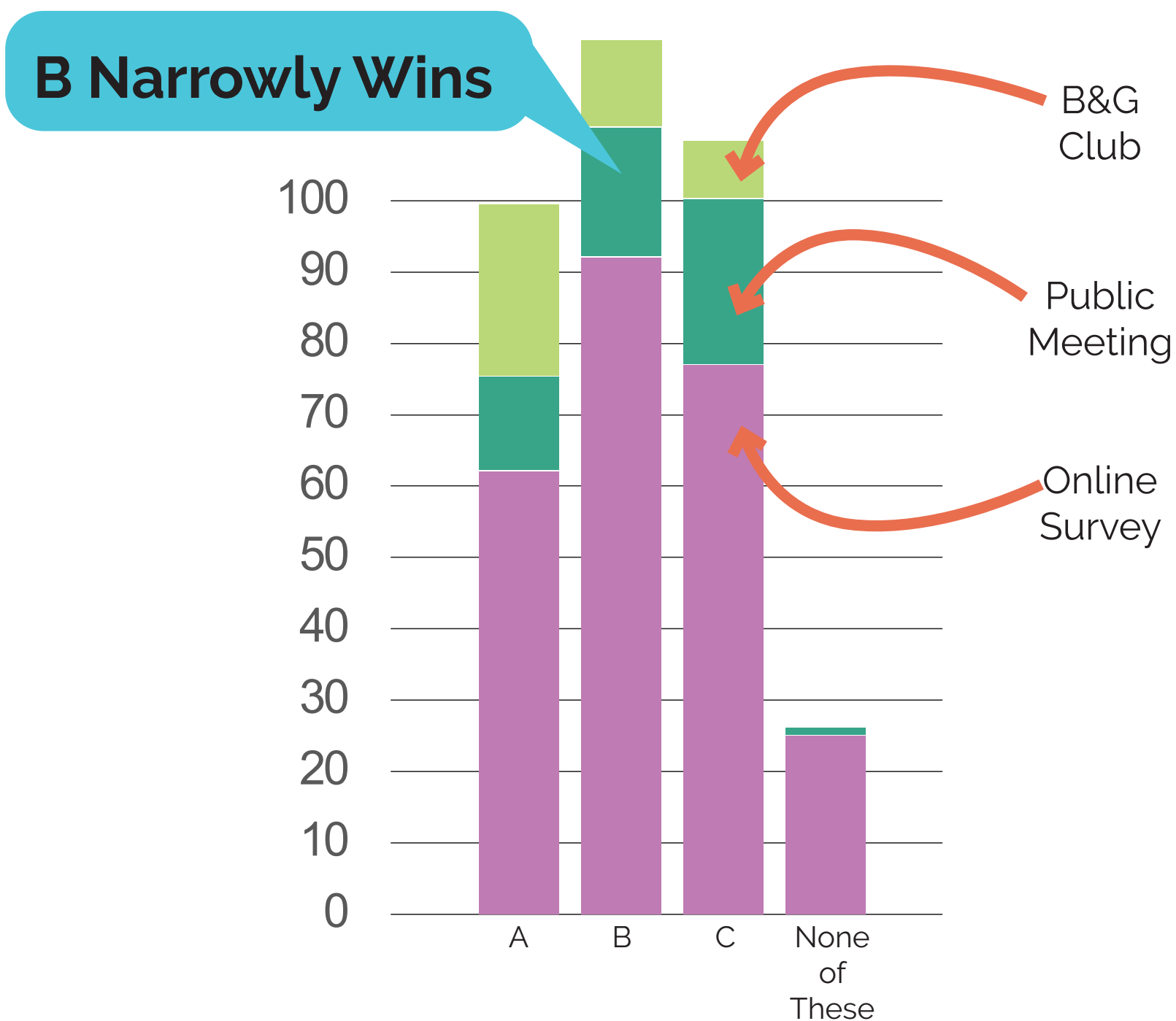

### What we heard:

- "Take it to the Court" received the most votes in total.
- "Play It Up!" was preferred by public meeting attendees.
- "Made in the Shade" was the favorite among B&G Club kids.
- The majority of the comments expressed support for Option B "Take it to the Court", especially the addition of rollerskating and skate features.
- Many people suggested a solid roof on the pavilion for rainy days.
- People liked the addition of seating in a 'relax' area in "Made in the Shade"

# Alternatives Outreach

## West Side

Key:

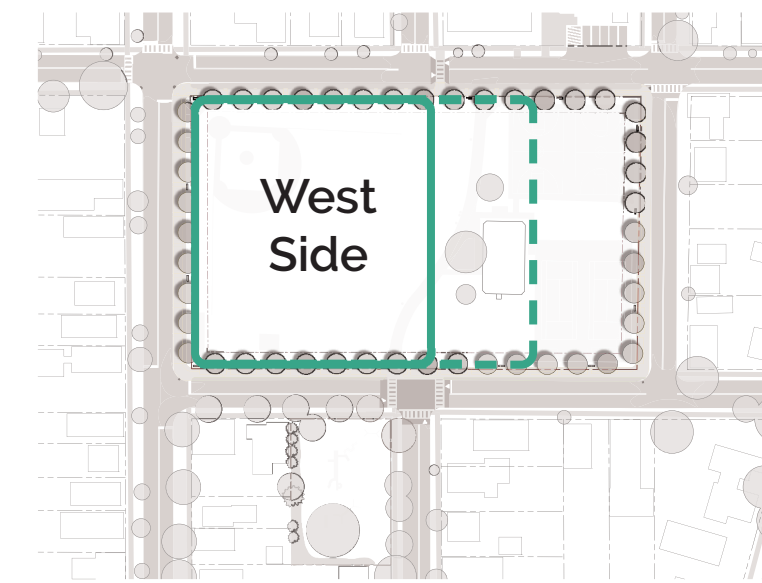

### Option A Scooch It In



### Option B Do The Twist

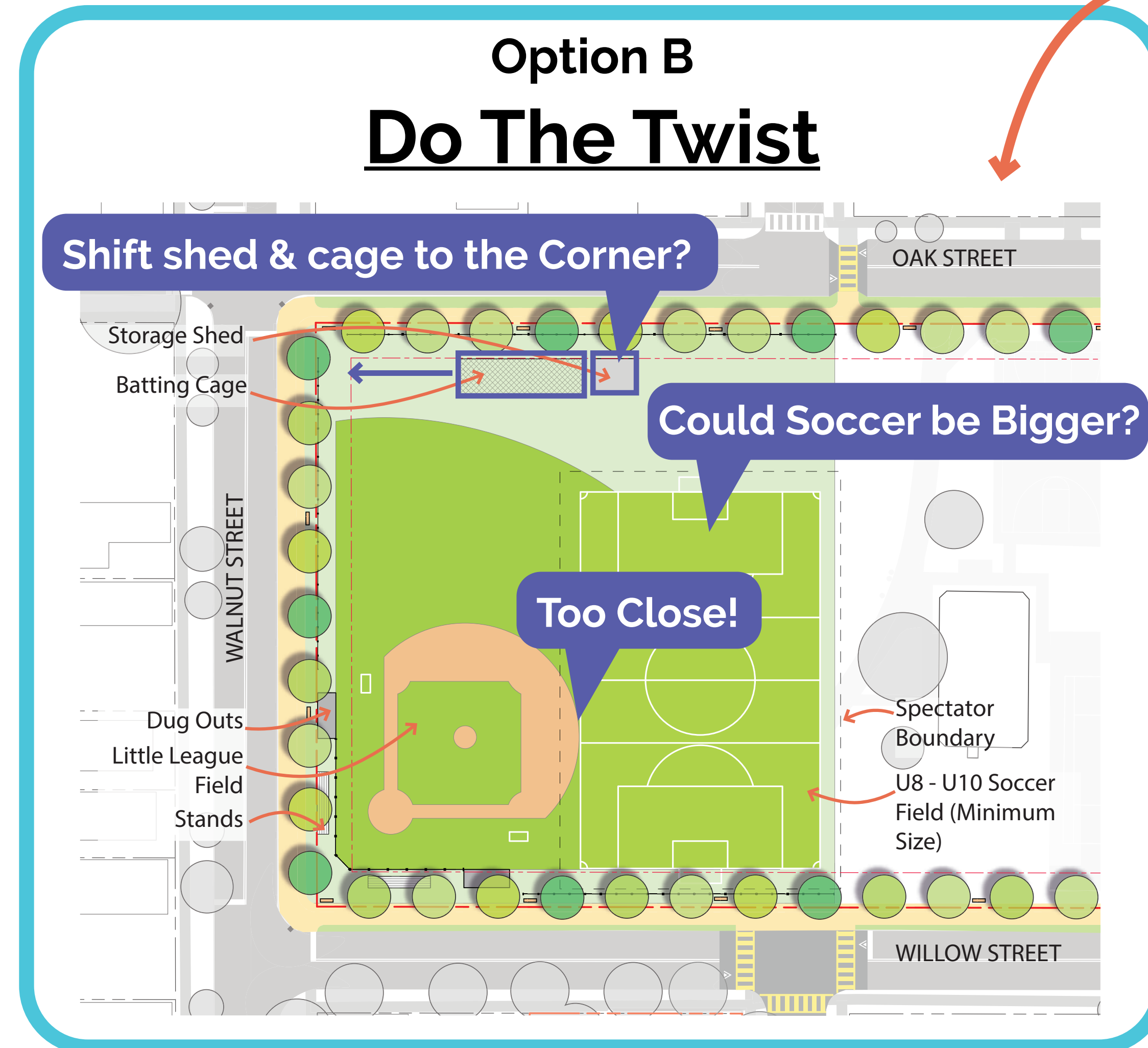

**Winner!**

### Option C Go BIG or Go Home

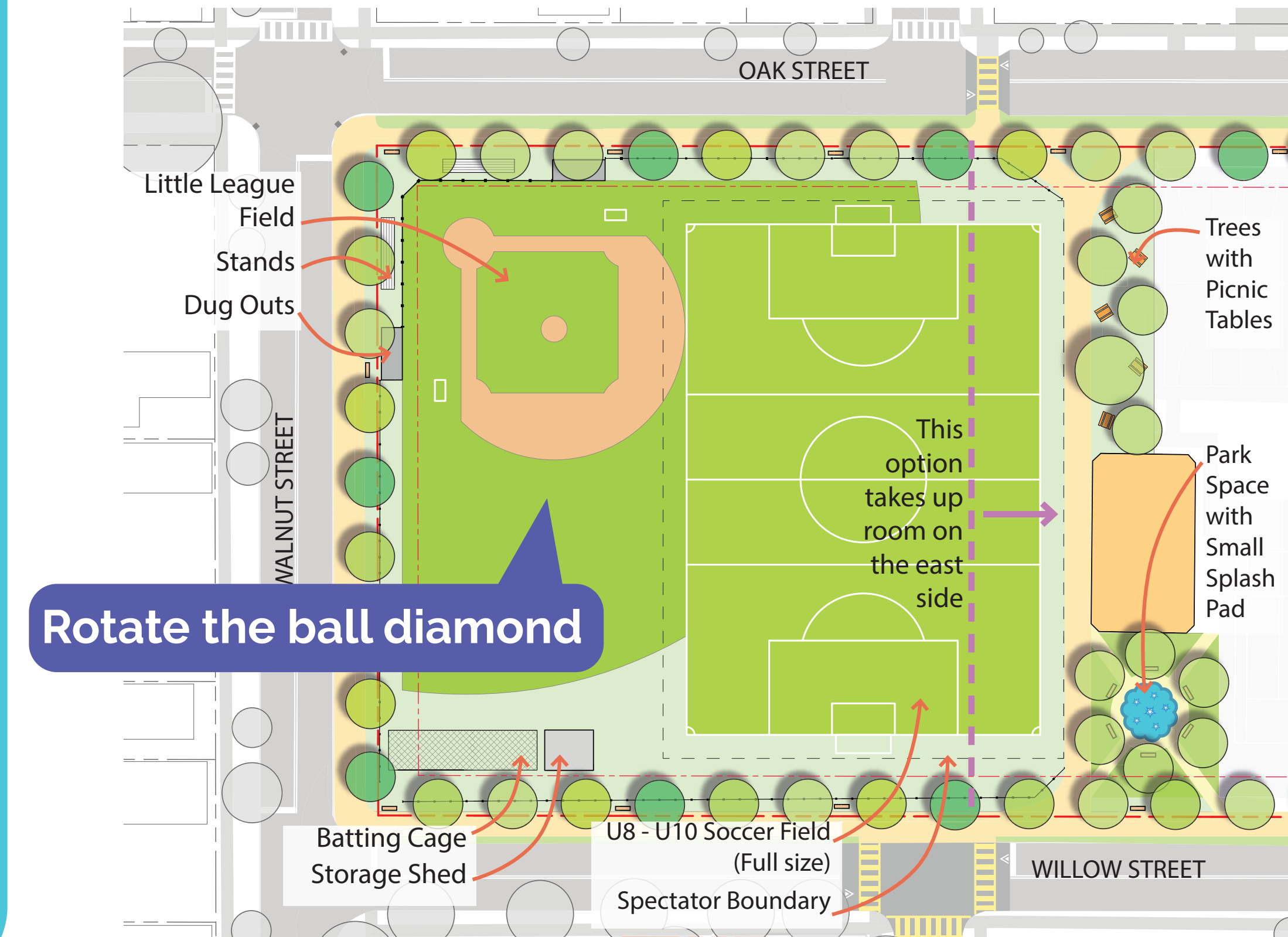

### West Side Individual Votes

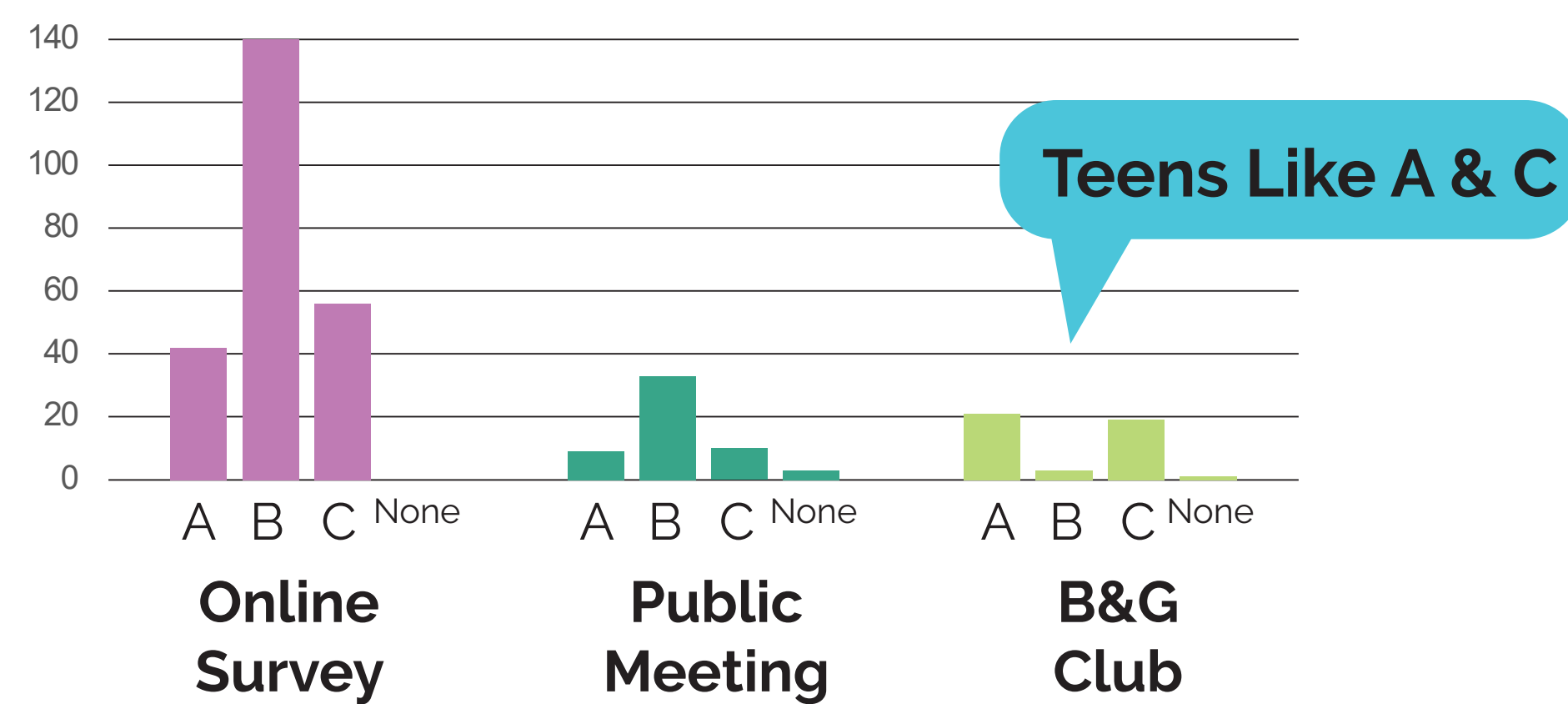

### West Side Total Votes

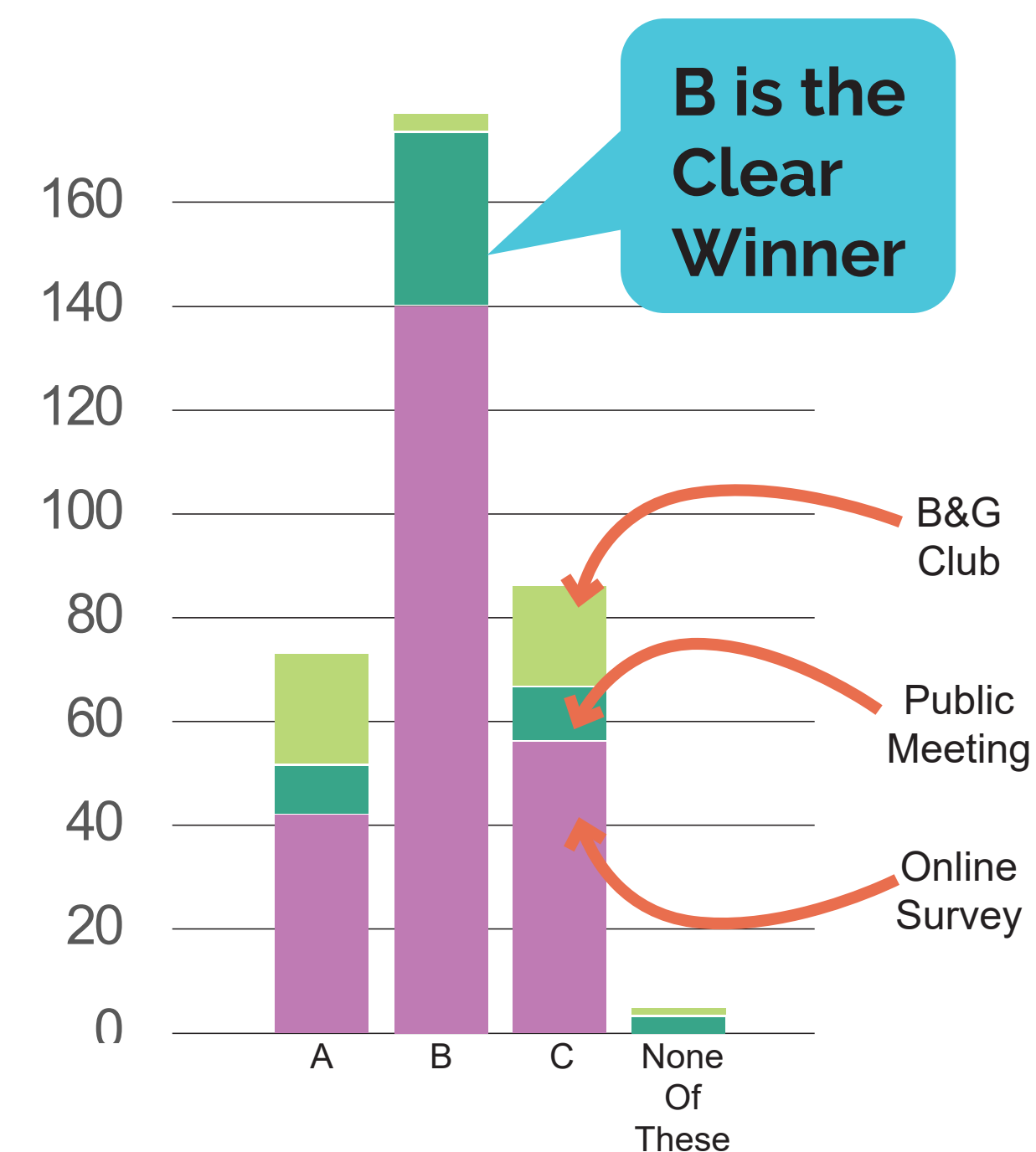

### What we heard:

- Option B, aka "Do the Twist," was preferred by a large margin by online survey respondents and public meeting attendees.
- The majority of the comments expressed support for the reoriented ball diamond and delineated soccer field.
- Most concerns related to the potential for conflict between the two sports (location, fences, fly balls, etc.).
- A few respondents wanted to rotate the ball diamond and enlarge the soccer field.

# Alternatives Outreach

## Lil' Rosie

Key:

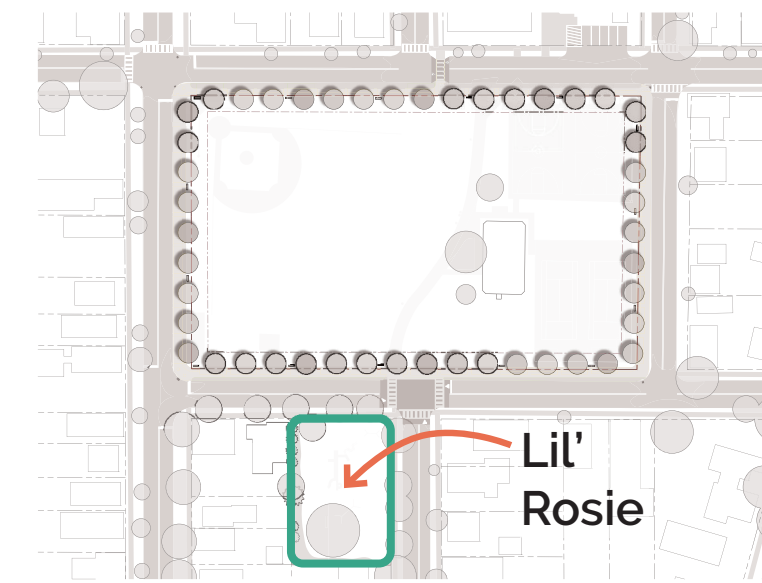

### Option A Play Reboot

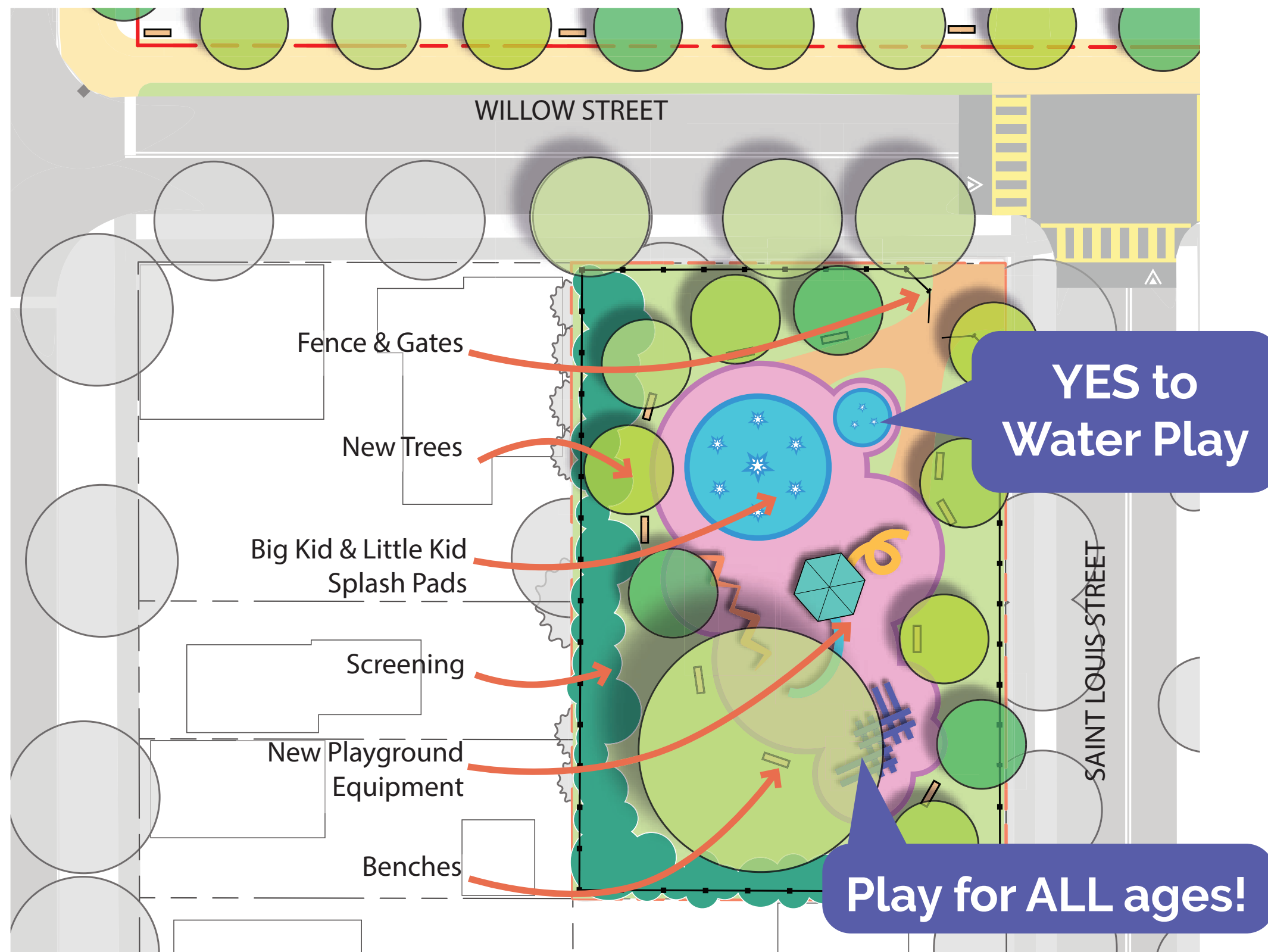

### Option B The Call of the Wild

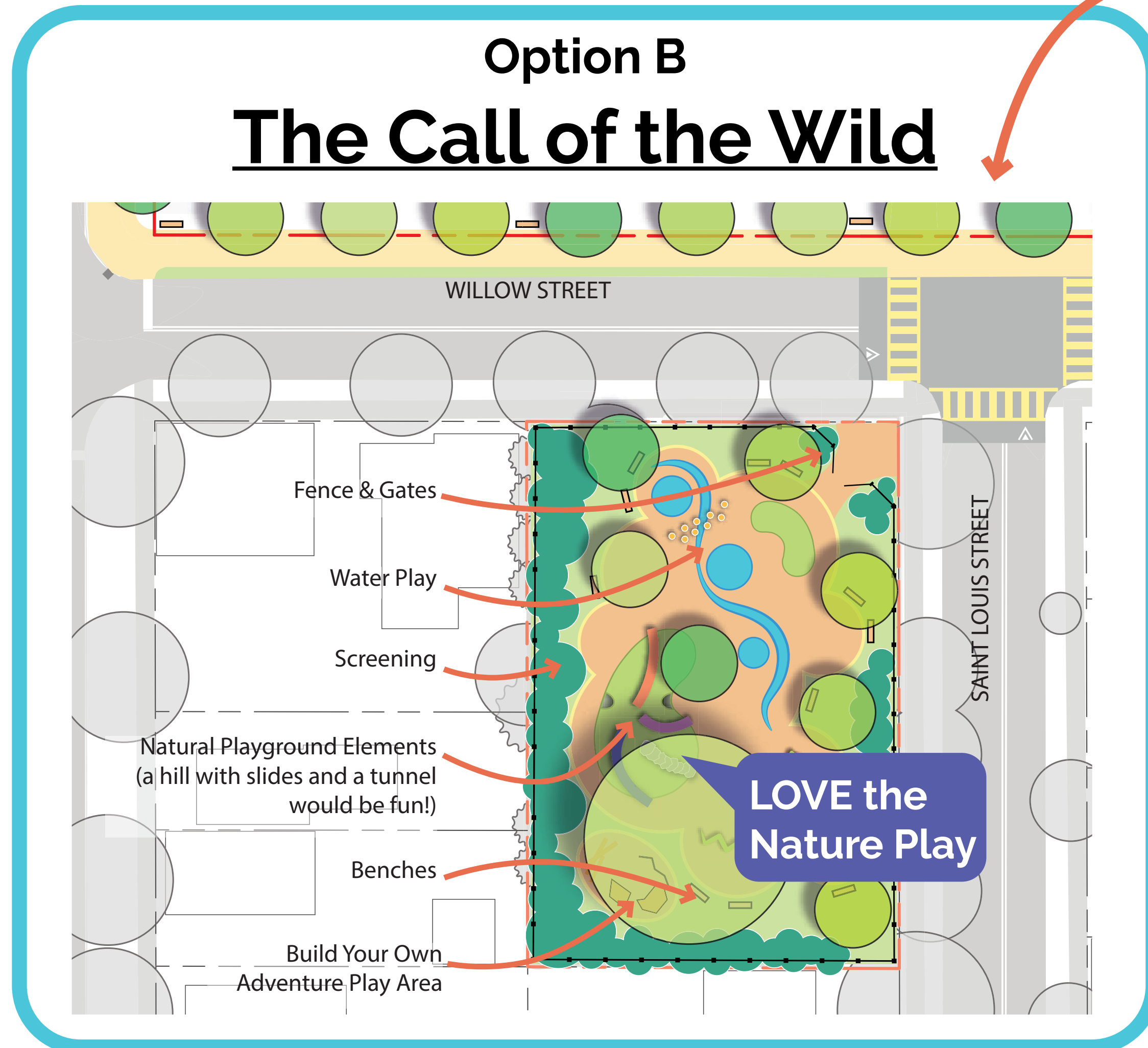

### Option C Take it Easy

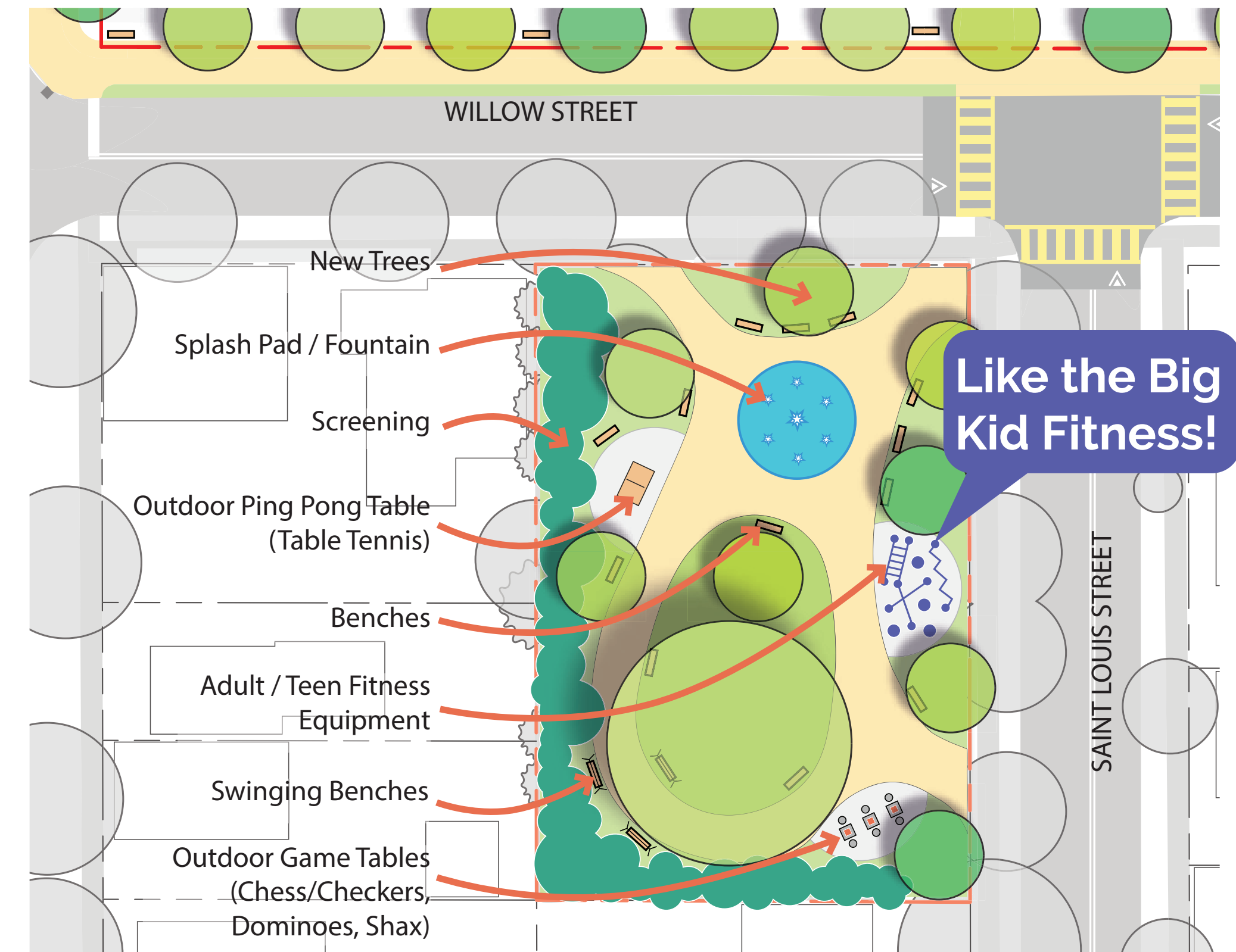

### Lil' Rosie Individual Votes

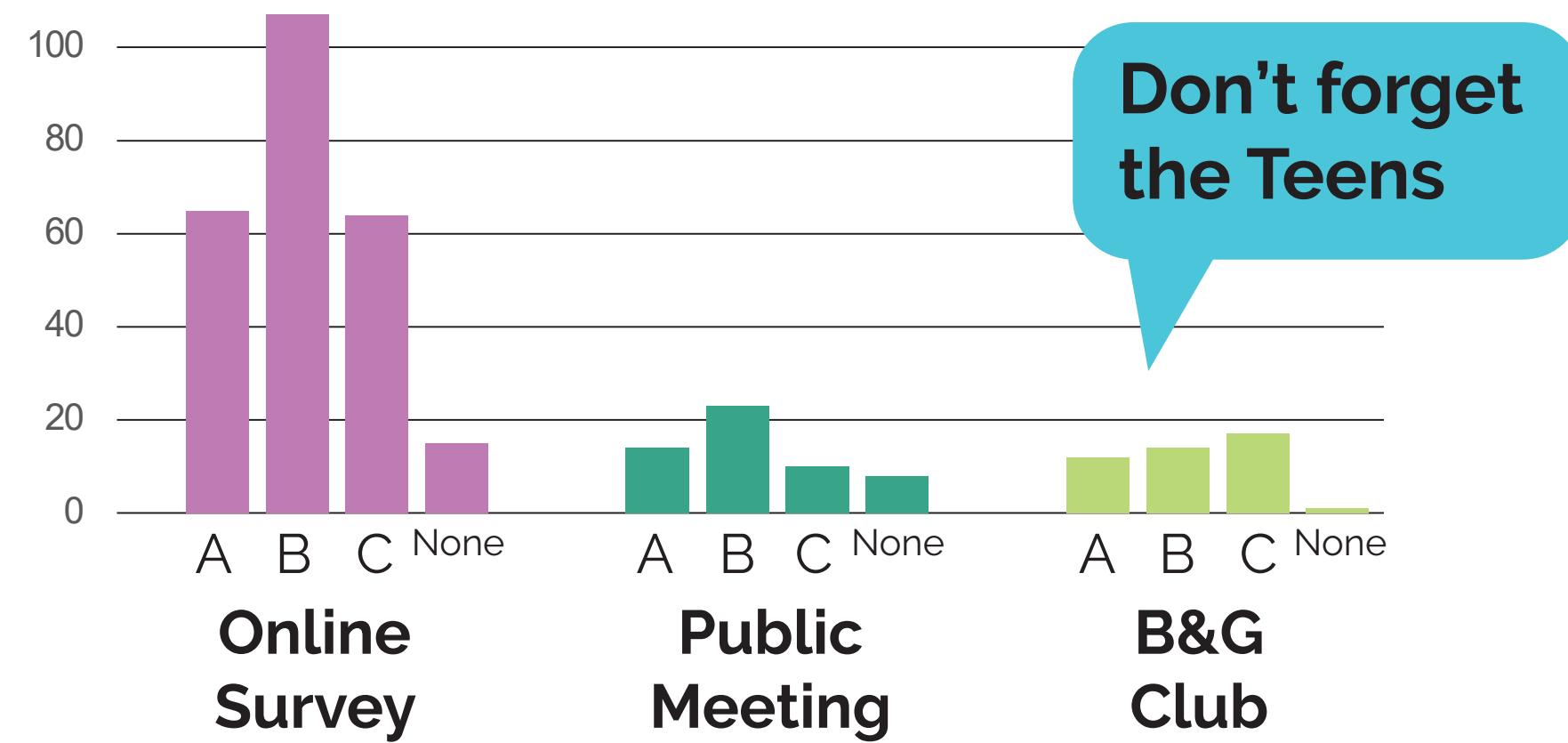

### Lil' Rosie Total Votes

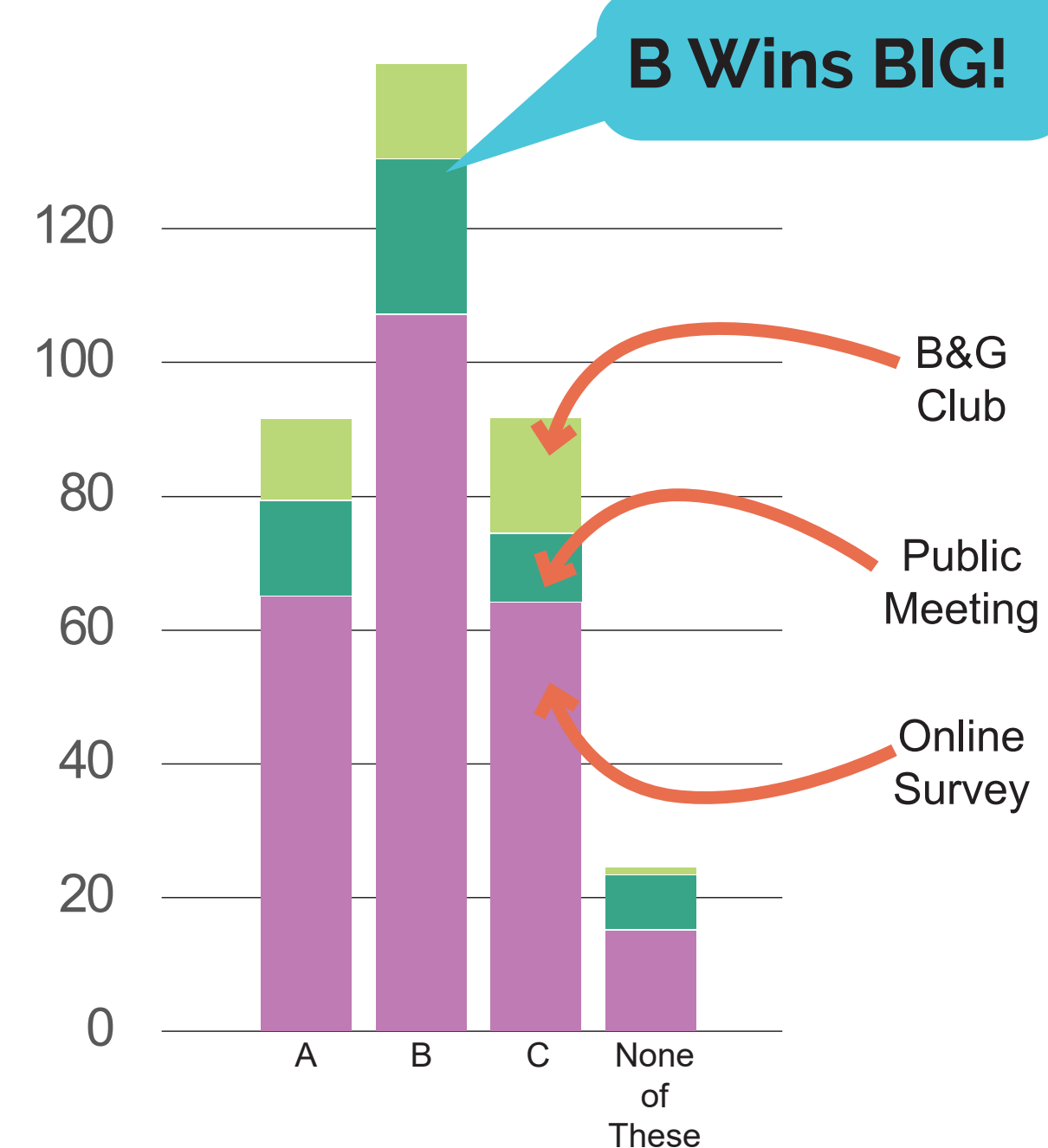

### What we heard:

- "Call of the Wild" (Option B) was highly supported for offering nature play rather than traditional equipment.
- Option B was preferred by online survey takers and public meeting attendees
- B&G Club slightly preferred "Take it Easy," which featured fitness equipment and big-kid play.
- Several comments expressed need for the water feature to be sustainable (water use and chemicals) and hygienic.

# Existing Conditions

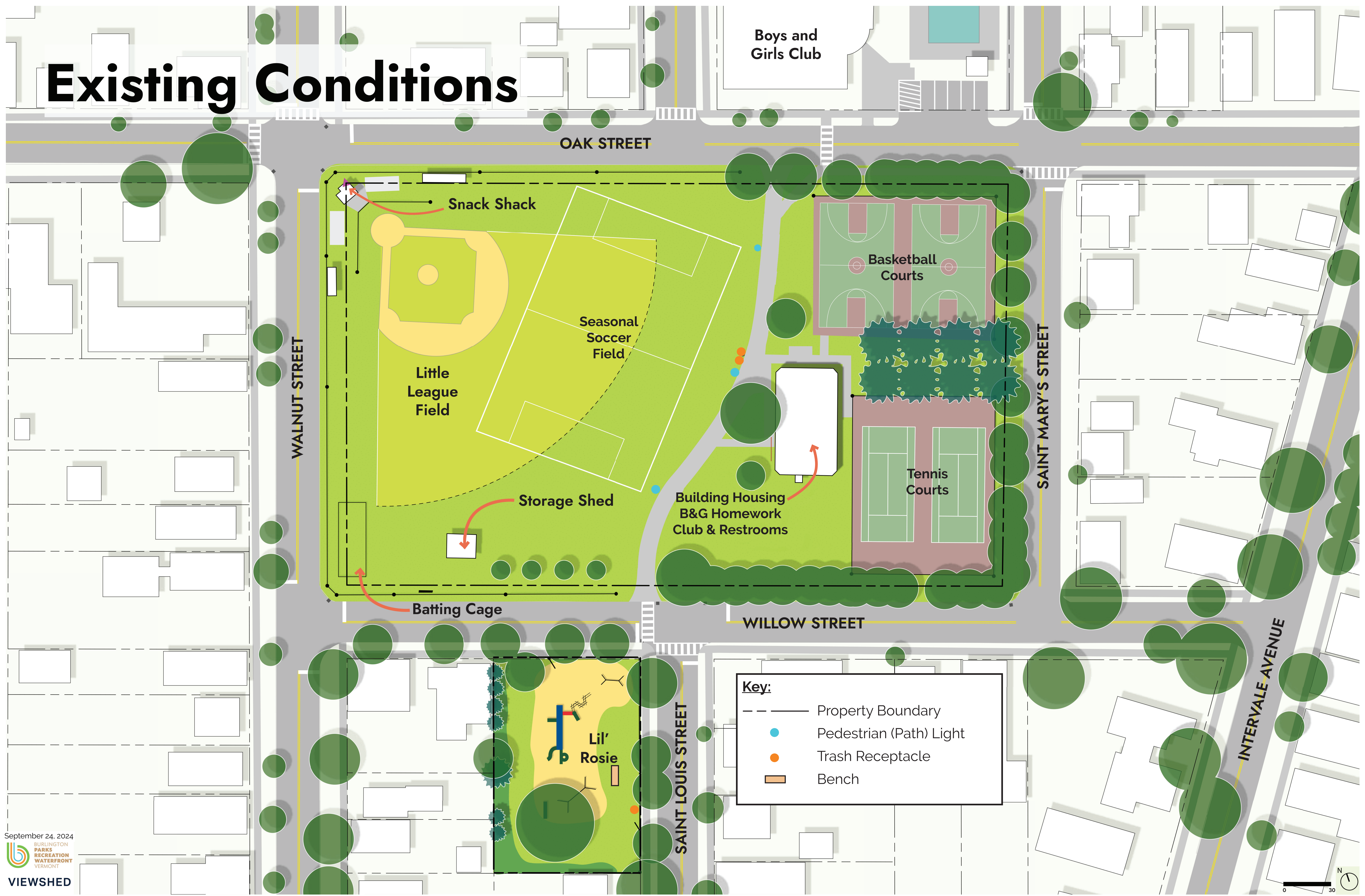

Boys and Girls Club

OAK STREET

WALNUT STREET

SAINT MARY'S STREET

WILLOW STREET

SAINT LOUIS STREET

INTERVALE AVENUE

Snack Shack

Basketball Courts

Seasonal Soccer Field

Little League Field

Storage Shed

Building Housing B&G Homework Club & Restrooms

Tennis Courts

Batting Cage

Lil' Rosie

**Key:**

- Property Boundary
- Pedestrian (Path) Light
- Trash Receptacle
- Bench

# BIG IDEA #1

## Improve Access

Safe access to the existing park is an issue. Fast traffic on Oak Street where the Boys and Girls Club members cross, lack of sidewalks around the park, kids crossing Willow Street to get from the main park to Lil Rosie, are all obstacles to access the park - especially for the little ones.



Sidewalks



Curb Extension



Raised Crosswalk



Tabled Intersection



H.A.W.K Crossing



Multi-use Path

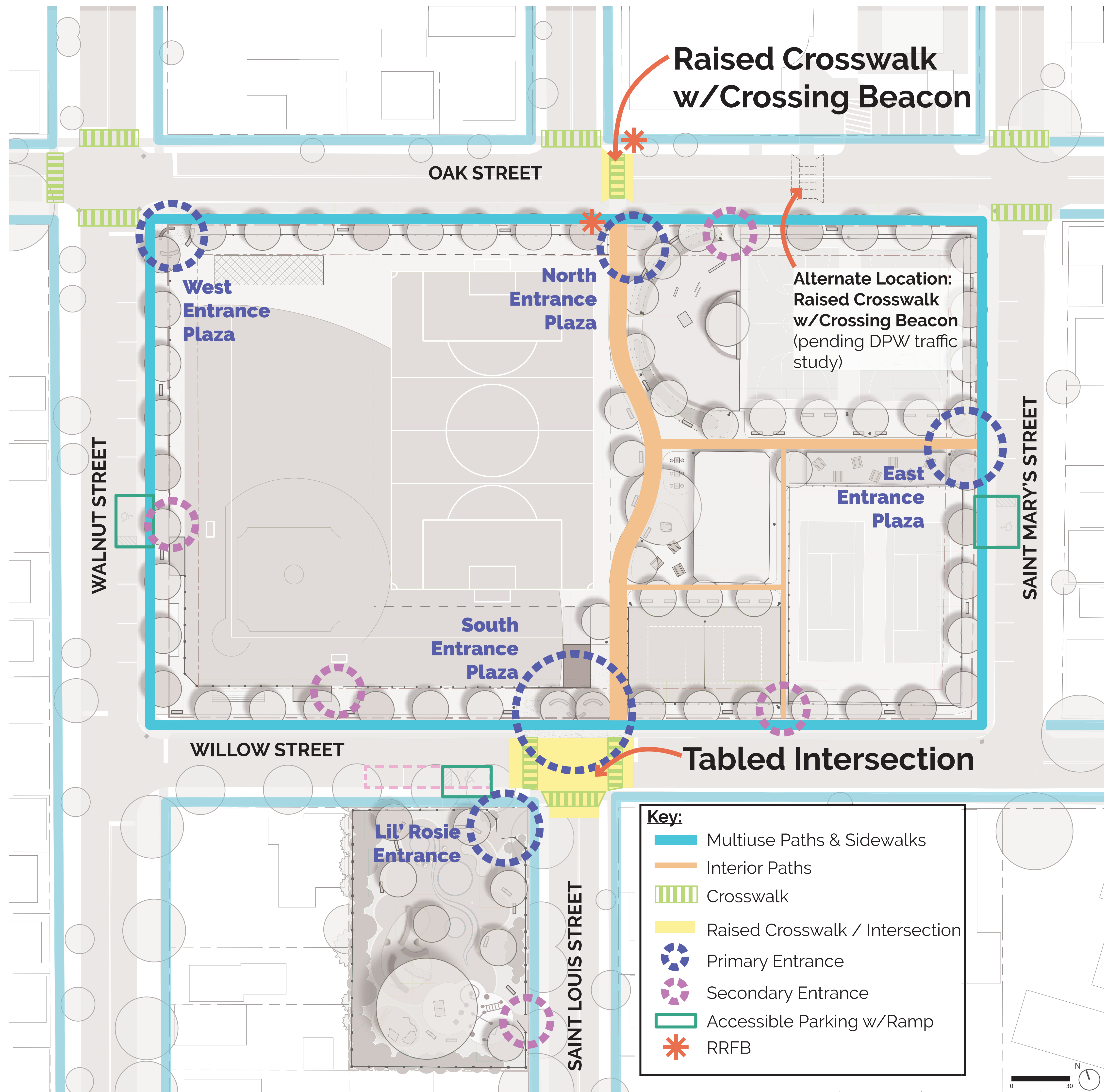

# BIG IDEA #2

## Add the Basics

We need to add the basics! Lack of seating, bike racks in need of repair, unreliable bathroom access, no place to gather and too few trash cans keep many neighbors from using the park for any extended period of time. At night, lack of lighting makes the park feel unsafe and in the summer the lack of shade makes hot days unbearable.



Picnic Tables



Bike Racks

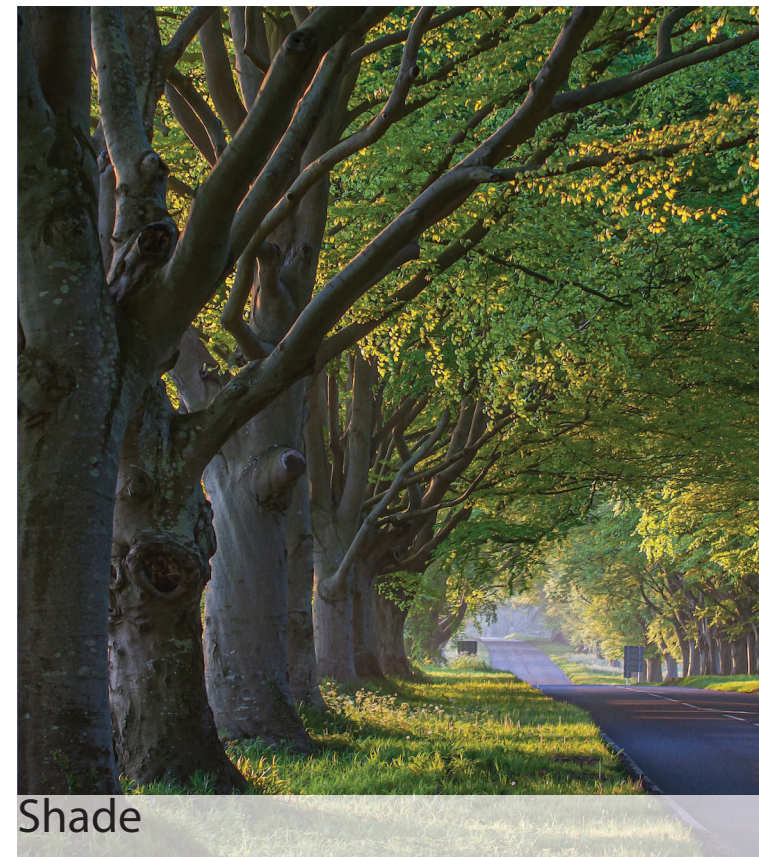

Shade



Night Lighting



Benches



Trash Cans

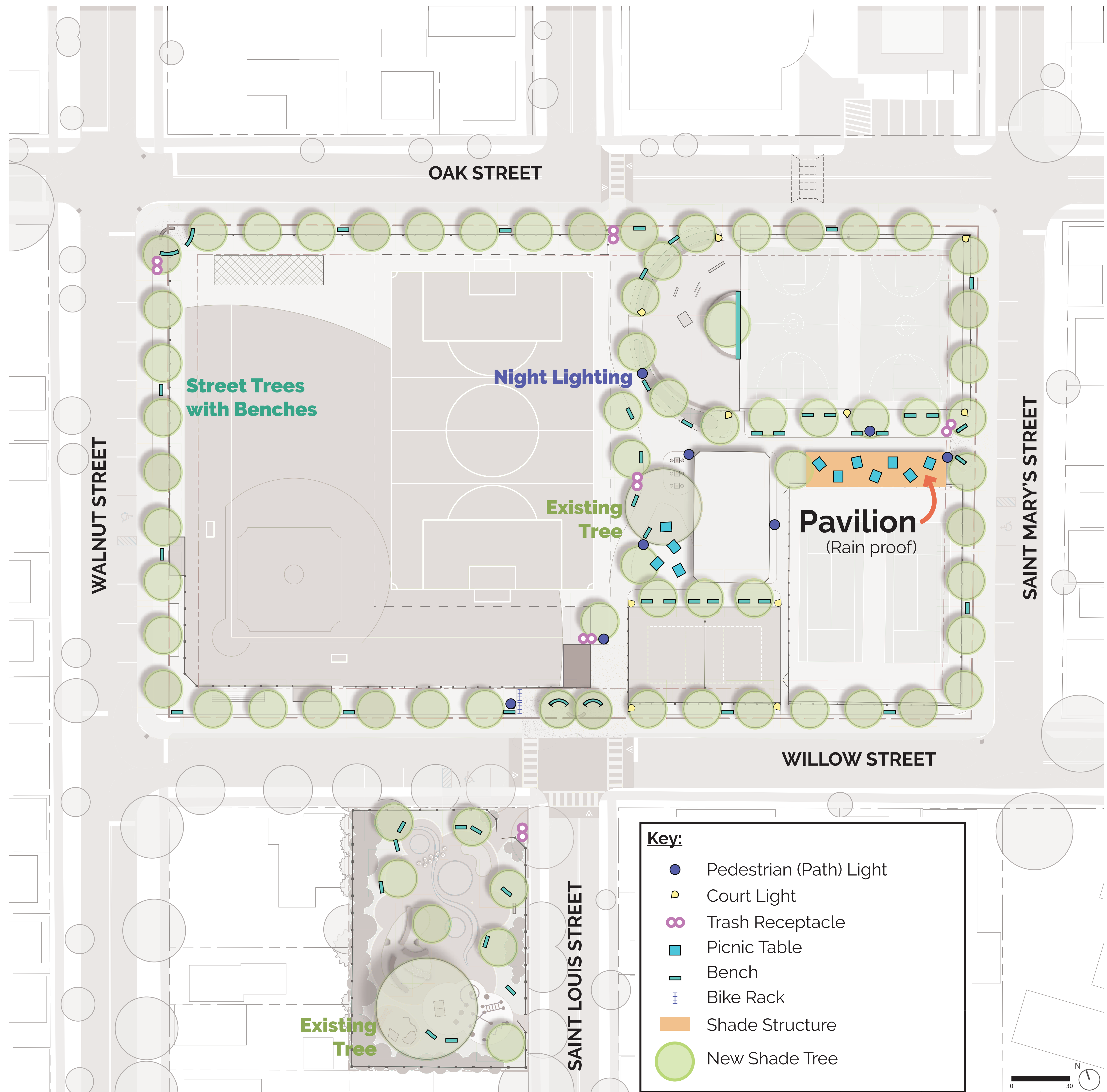



# BIG IDEA #3

## Fill the Gaps

Roosevelt Park already has great assets - basketball courts, tennis courts, a playground, a water fountain, and the Little League field too. But there's lots of room for improvement - residents want a permanent soccer field, reliable skate park amenities, a place to roller skate, a spot to play volleyball, more space for Kids on the Ball, game tables (chess/checkers/Shax/Ping Pong) and a public place for kids to cool off during hot summer days.



Roller Skate Rink



Flexible Field (Kids on the Ball Expansion Area)



Permanent Soccer Field



Water Play



Volleyball

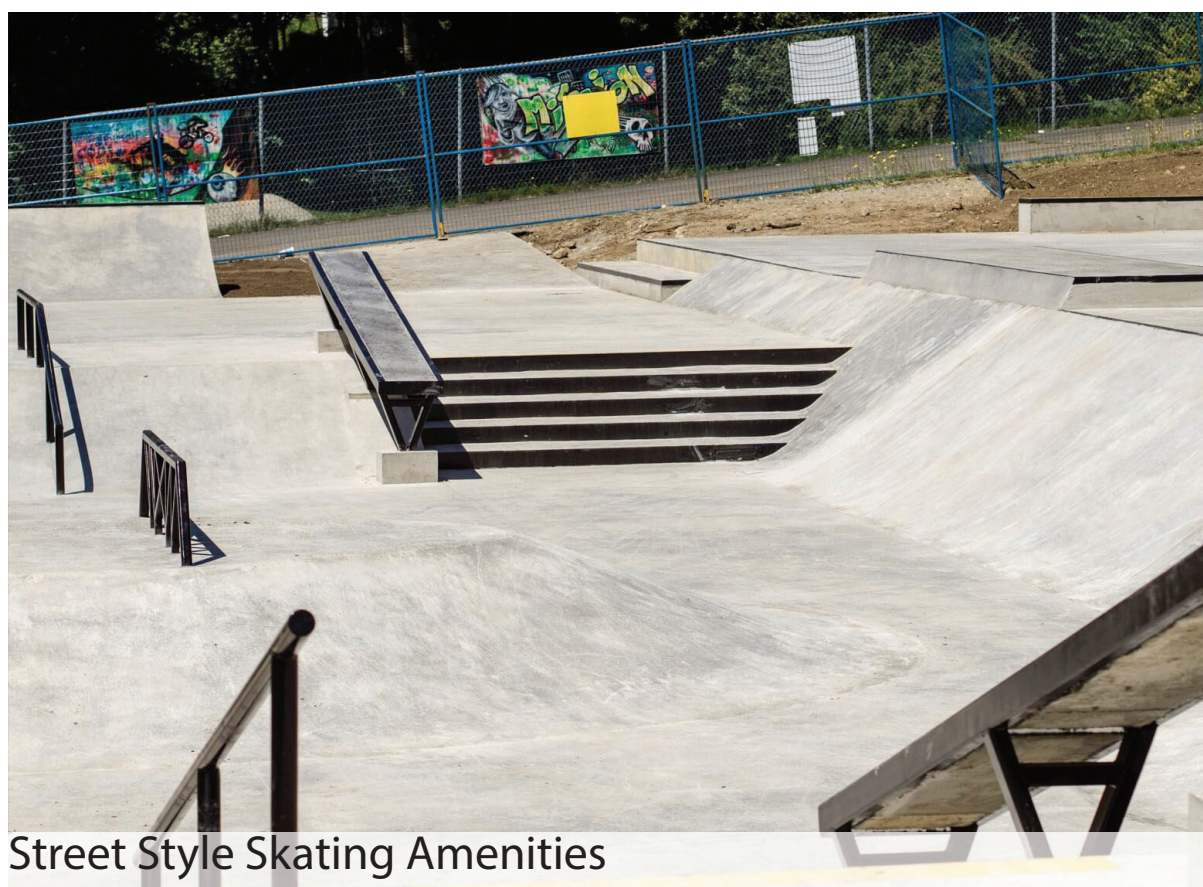

Street Style Skating Amenities

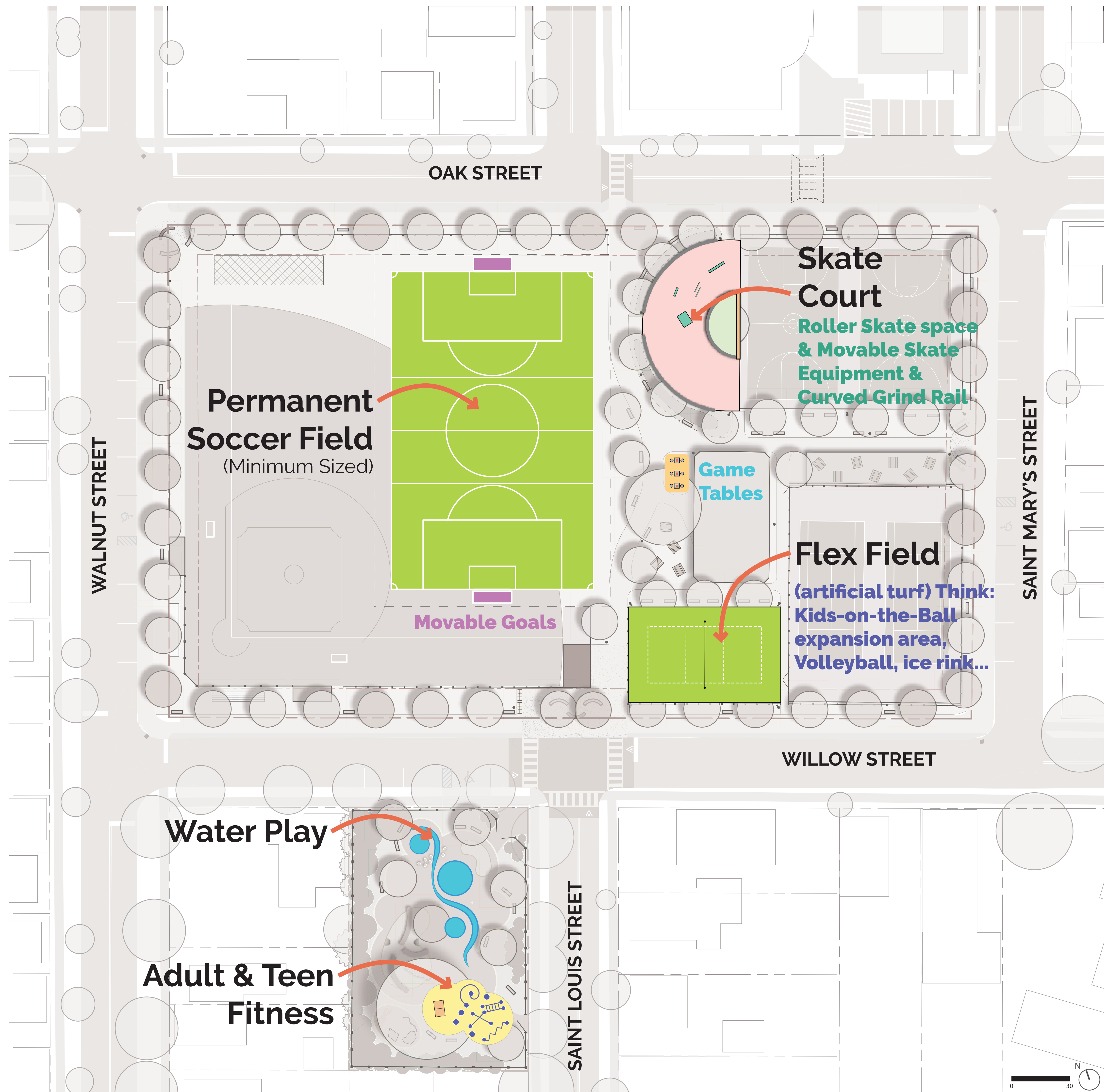

# Framework

## Oak Street & Willow Street

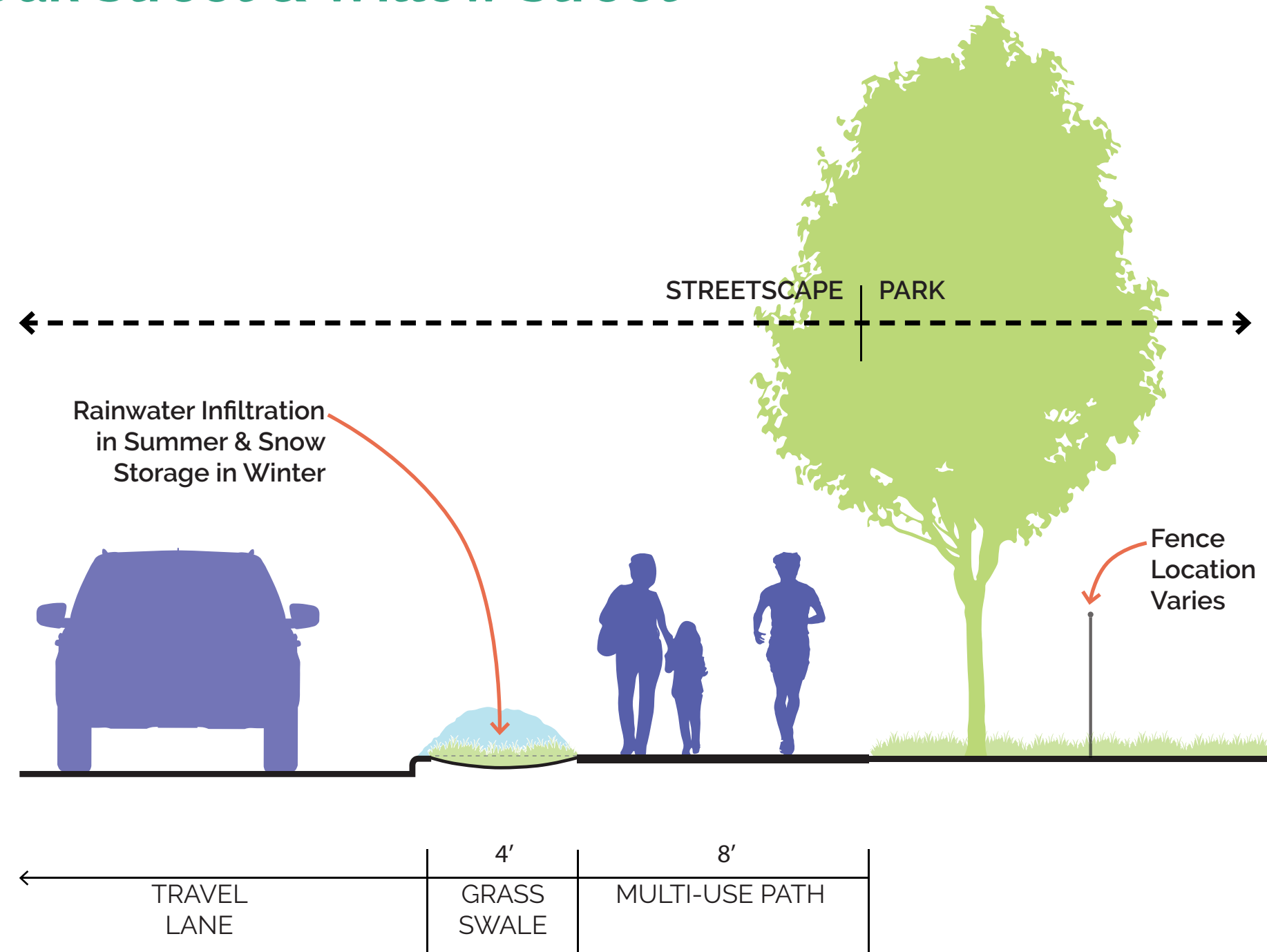

## Walnut Street & Saint Mary's Street

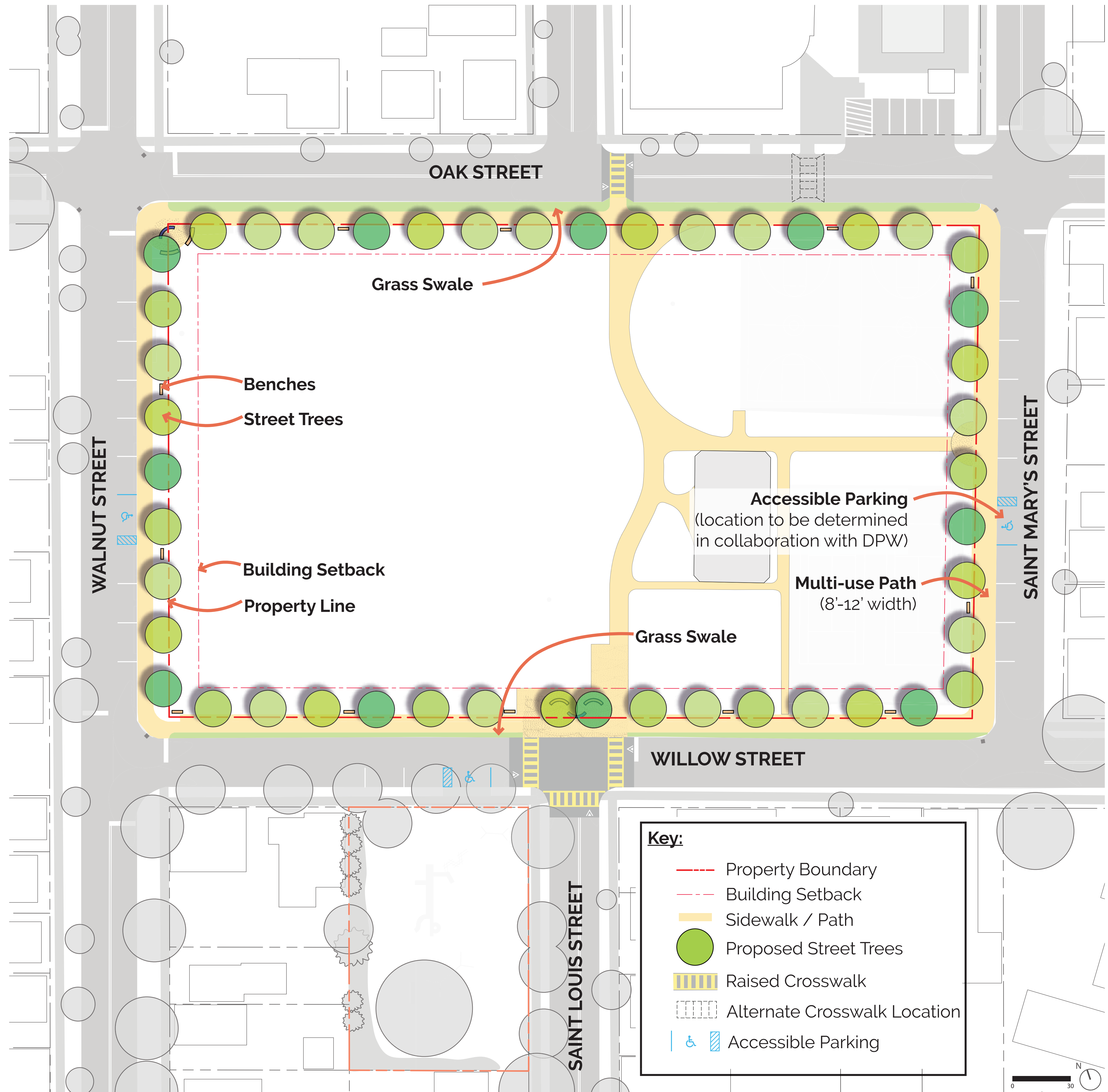
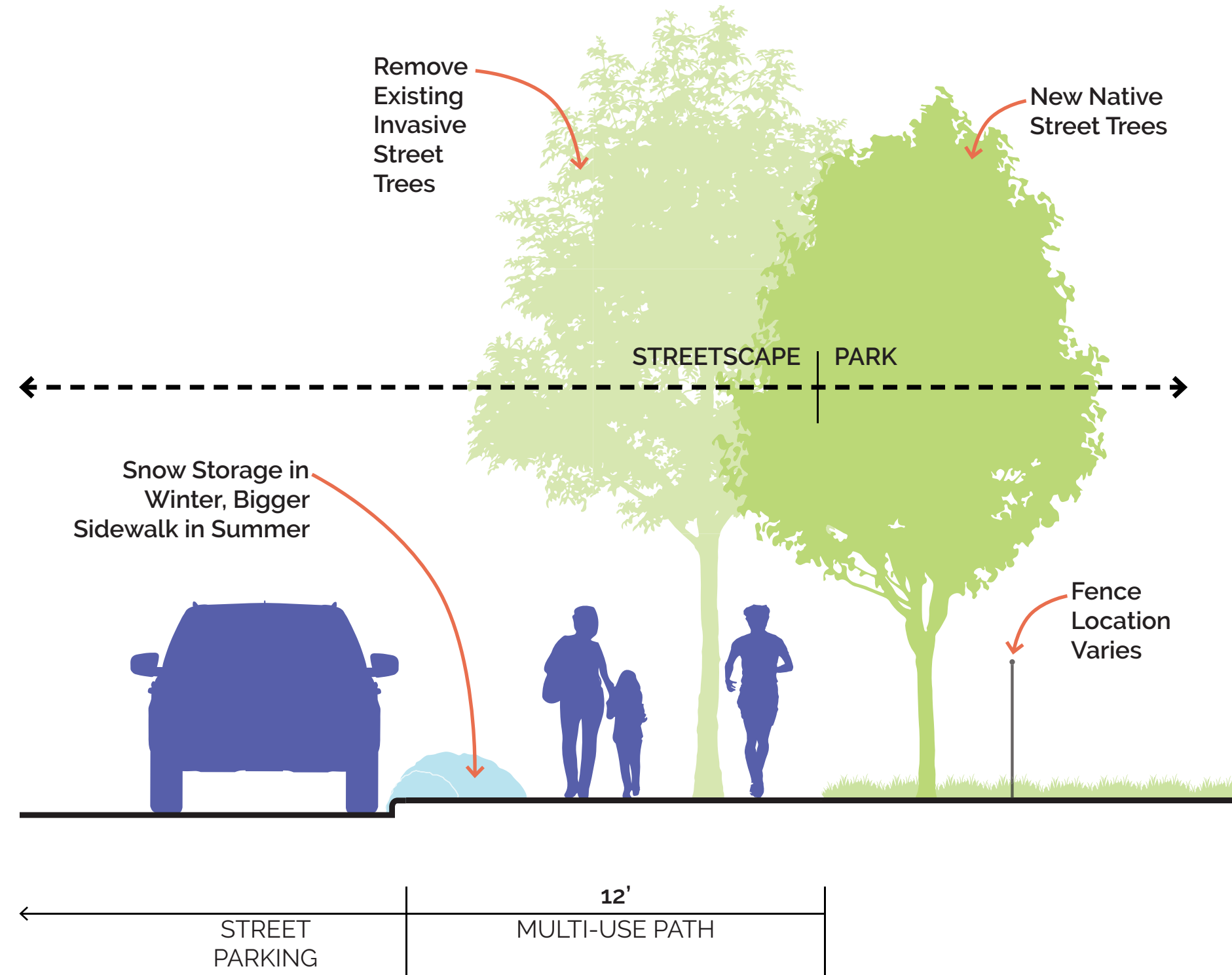

# Proposed Comprehensive Plan



**Key:**

- Property Boundary
- Building Setback
- Soccer Field Spectator Line
- Fence
- Bench
- Picnic Table

# Priority Planning

Help the City Determine what project you would like to build first!

Place your sticker on what you want built FIRST!

