

Project Background

What is a Comprehensive Plan?

A map of long-range improvements and changes.

It includes information about the park's current conditions and envisions the changes that are possible for a park. The plan also details how the public is included in the process and illustrates the steps taken towards a final plan for the future of the park.

Want to find out more about Roosevelt Park's new comprehensive plan and keep up with the latest news?

Visit [<bitly link>](#) or scan this QR code



Schedule

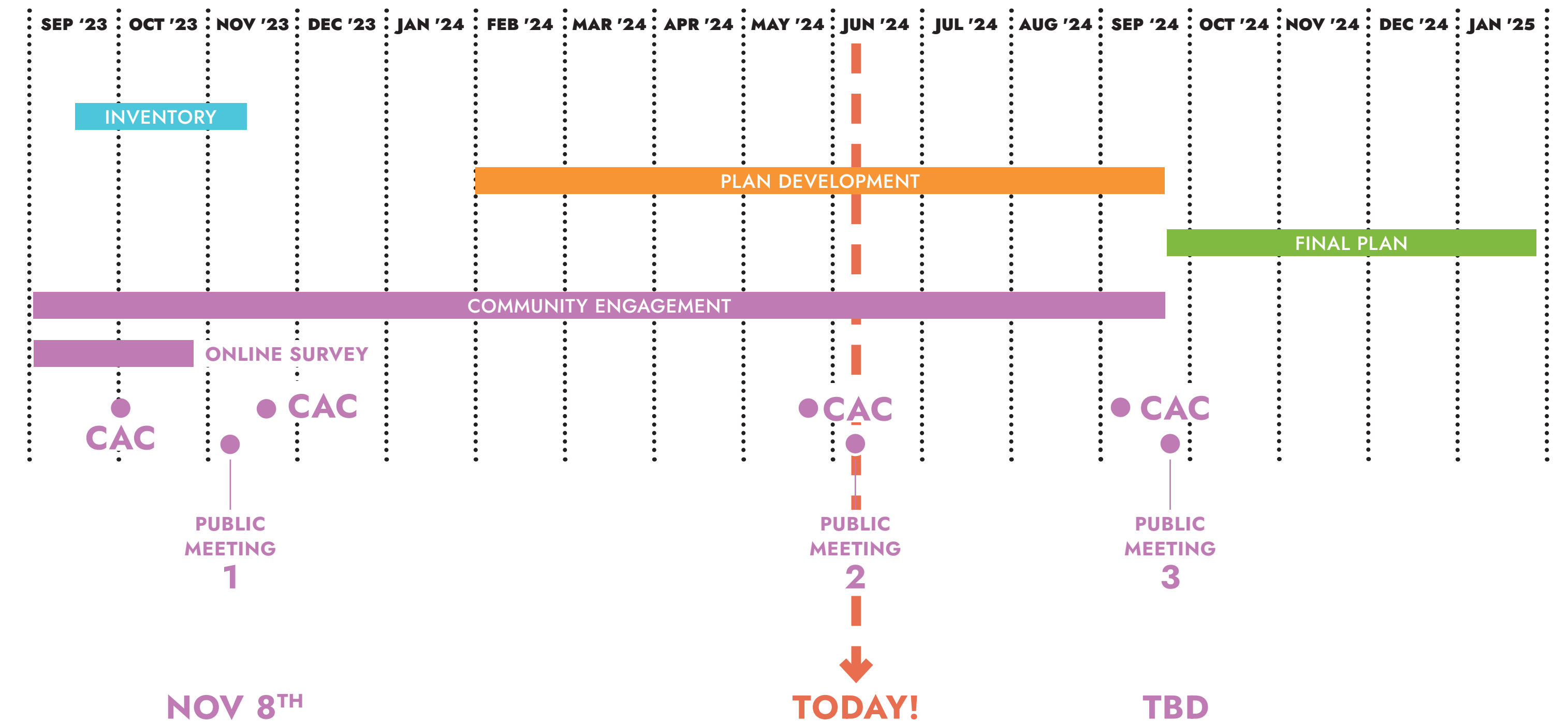

Online Survey Results

From September through October 2023, the public was invited to voice what works, doesn't work, or is missing from the park in an online survey.

Here are the highlights:

Non-Sports

- **More comfort!** Top responses included seating, shade, and drinking fountains.

PRIORITIZE WHAT IS NEEDED IN THE PARK (NON-SPORT)

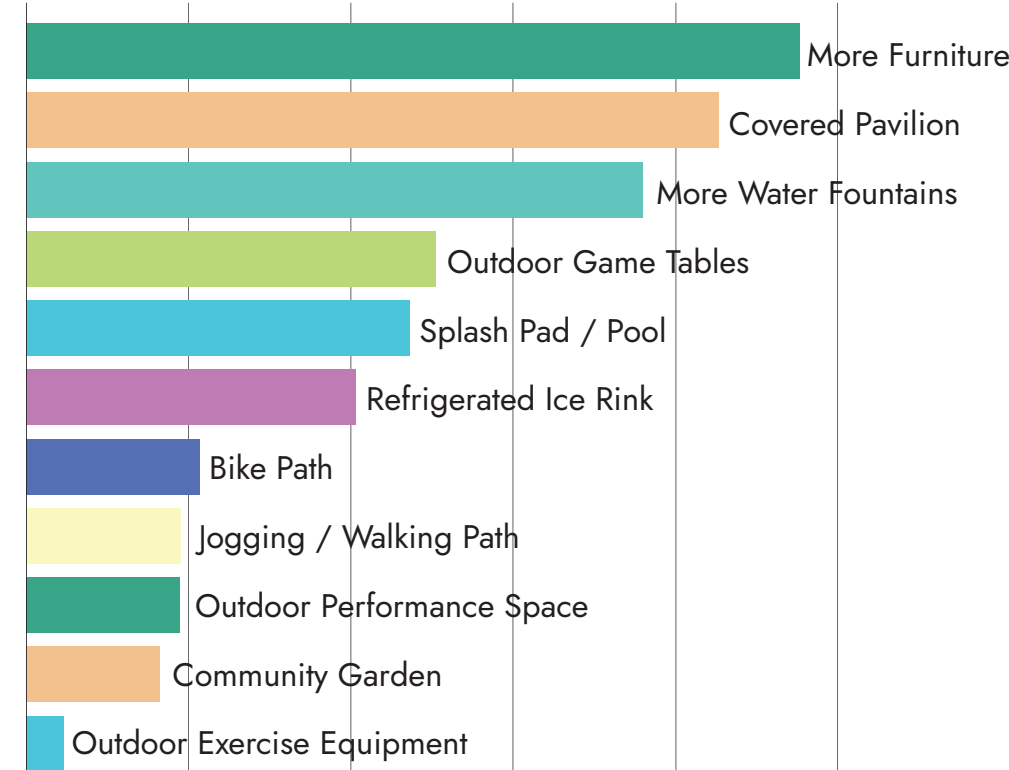

Organized Sports

- **Most people play/watch Soccer and Little League, Tennis and Basketball.**

WHAT SPORTS DOES YOUR FAMILY PLAY OR WATCH IN THE PARK?

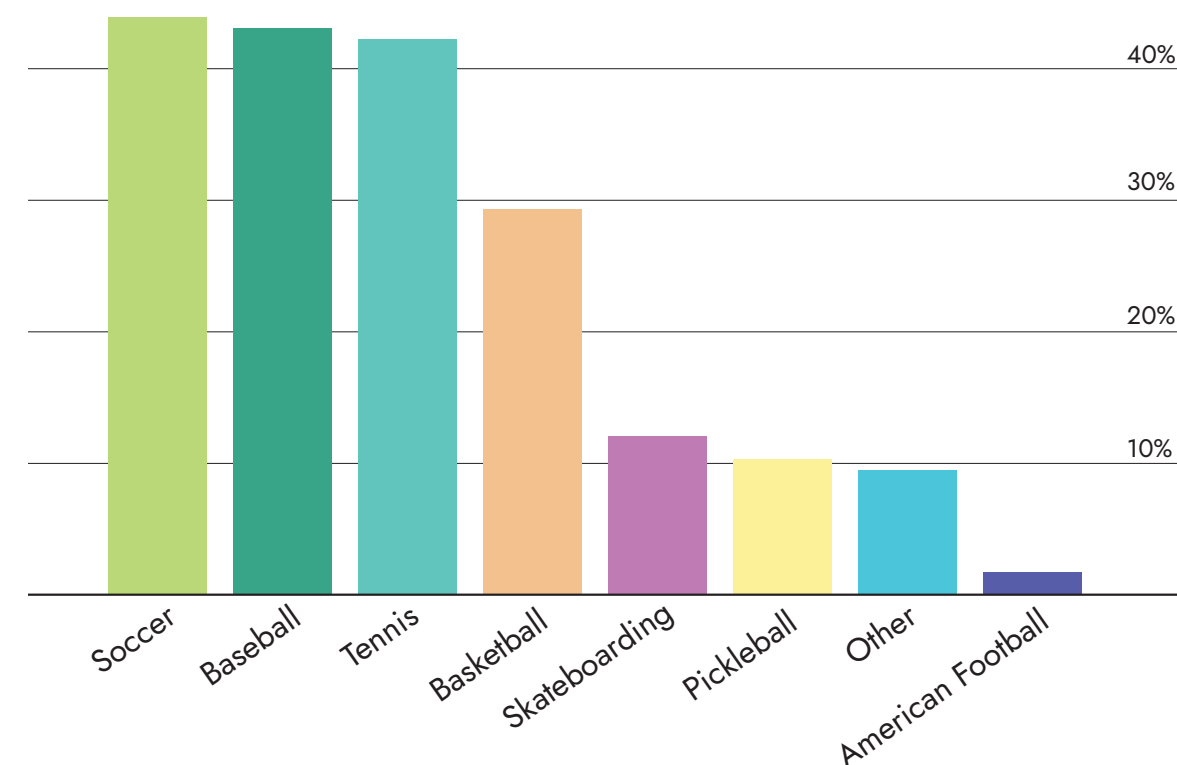

Stakeholders

From February through May 2024, City Staff met with key stakeholder groups who have a vested interest in the park's development plans. This is a list of who was interviewed:

- Boys and Girls' Club - Staff
- Richard Kemp Center - Reverend Mark Hughes
- VT Racial Alliance - Isaac Owusu
- AALV - Samuel Dingba
- Trusted Community Voices - Mona Tolba
- Integrated Art Academy - Staff
- Burlington Children's School - Staff + Parents

Some of what we heard:

- **Dogs are a major problem** (off leash + lack of waste disposal)
- **Better restroom access is needed**
- **Lighting, shade & seating are lacking**
- **Splash pad or pool would be loved**
- **Issues with safety and safe access**
- **Covered gathering space is needed**
- **Fencing is a must**

Public Meeting #1

On November 8, 2023, a public meeting was held to ask Burlingtonians about what their priorities are in the park and what they would do to improve the park. Here's a quick summary of the engagement activities:



What are your priorities?

- **Soccer Field is in for the win!**
- **Baseball Field, Roller Skating Rink and Skate Park are in demand too!**

Design Your Park Takeaways

- **Don't throw the baby out with the bath water!** Keep what's there - it's working!
- **Stack uses:** Courts and fields can be used for more than one activity!

RANK YOUR PRIORITIES (STICKER EXERCISE)

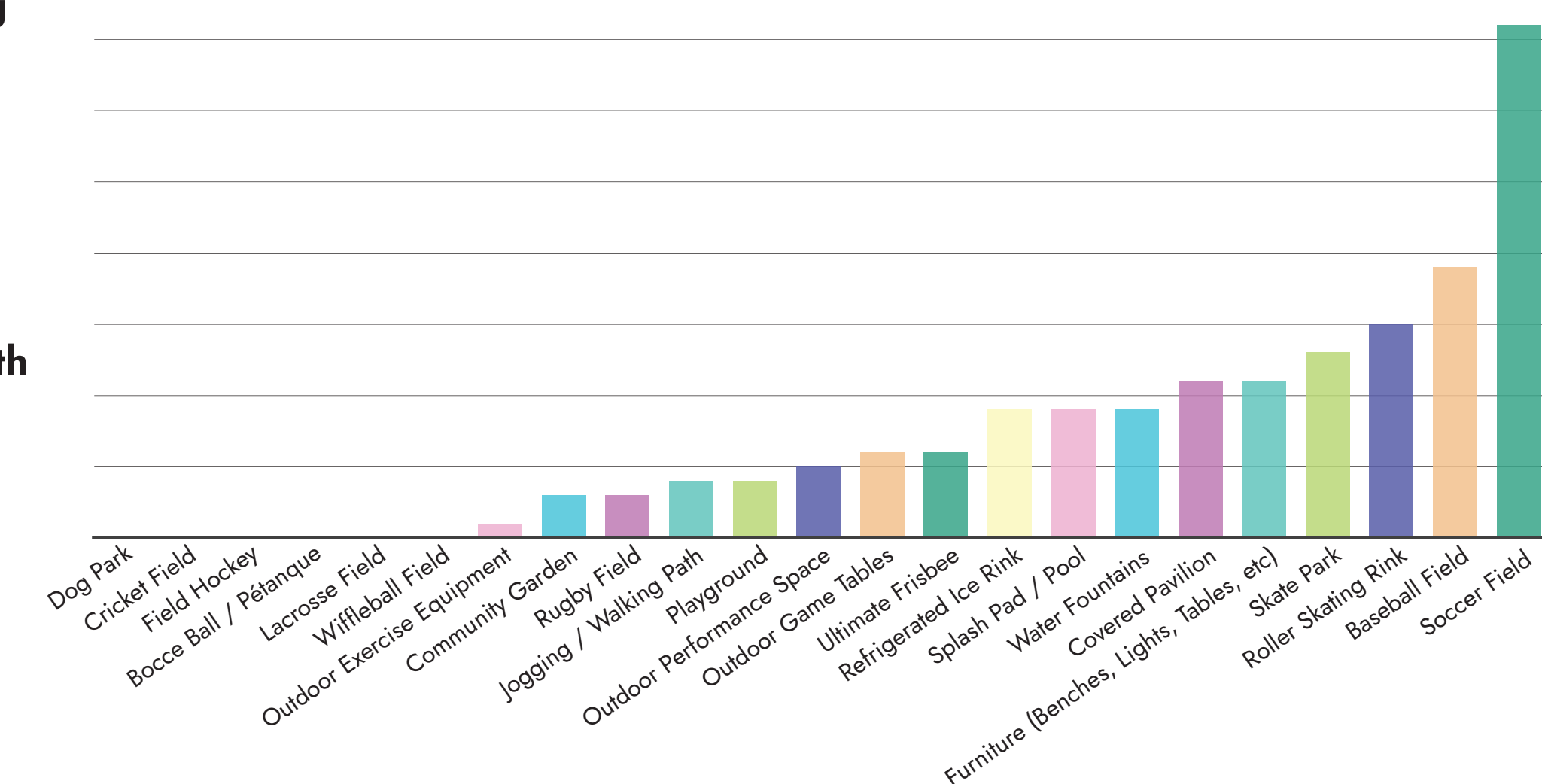

Existing Conditions

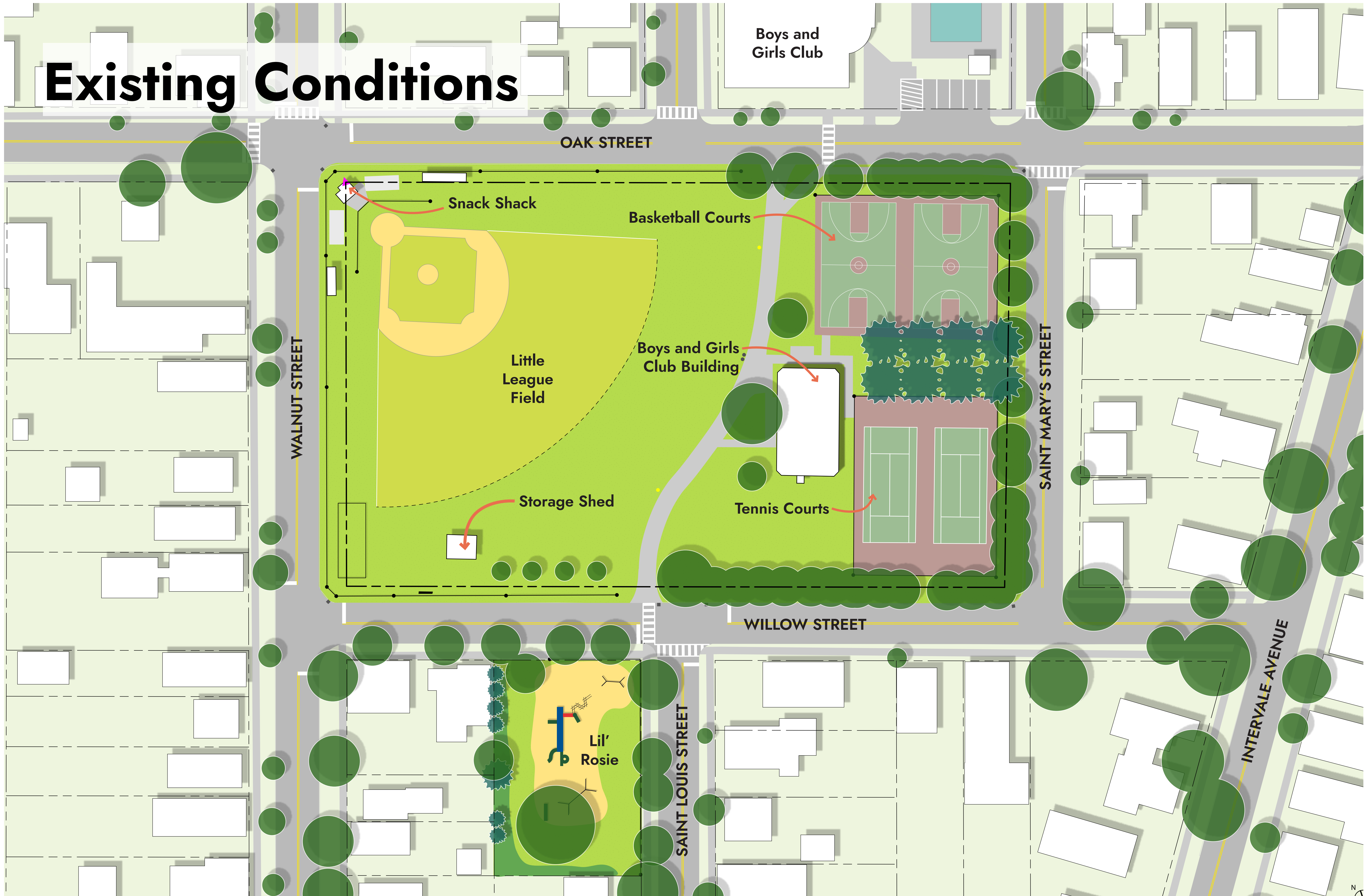

Boys and Girls Club

OAK STREET

Snack Shack

Basketball Courts

Little League Field

Boys and Girls Club Building

Storage Shed

Tennis Courts

SAINT MARY'S STREET

WILLOW STREET

Lil' Rosie

SAINT LOUIS STREET

INTERVALE AVENUE

Big Ideas

After the online survey, public meeting, chats with the Citizens Advisory Committee (CAC), and interviews with key stakeholder groups, three major themes emerged on how to improve the park:

Access

Save access to the park is an issue. Fast traffic on Oak Street, lack of sidewalks around the park, kids crossing Willow Street to get from the main park to Lil Rosie, and Boys and Girls Club members crossing Oak Street are boundaries to the park - especially for the little ones.



Sidewalks



Curb Extension



Raised Crosswalk



Tabled Intersection

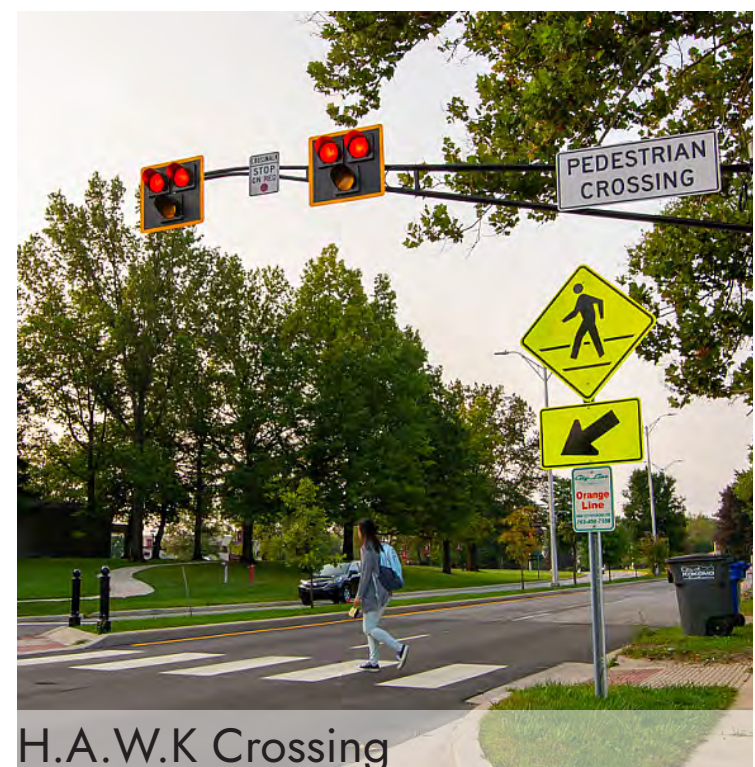

H.A.W.K Crossing



Sidewalk with Jogging Track

Add the Basics

We need to add the basics! Lack of seating, bike racks in need of repair, unreliable bathroom access, and too few trash cans keep many neighbors from using the park for any extended period of time. At night, lack of lighting makes the park feel unsafe and in the summer the lack of shade makes hot days unbearable.



Picnic Tables



Bike Racks



Shade

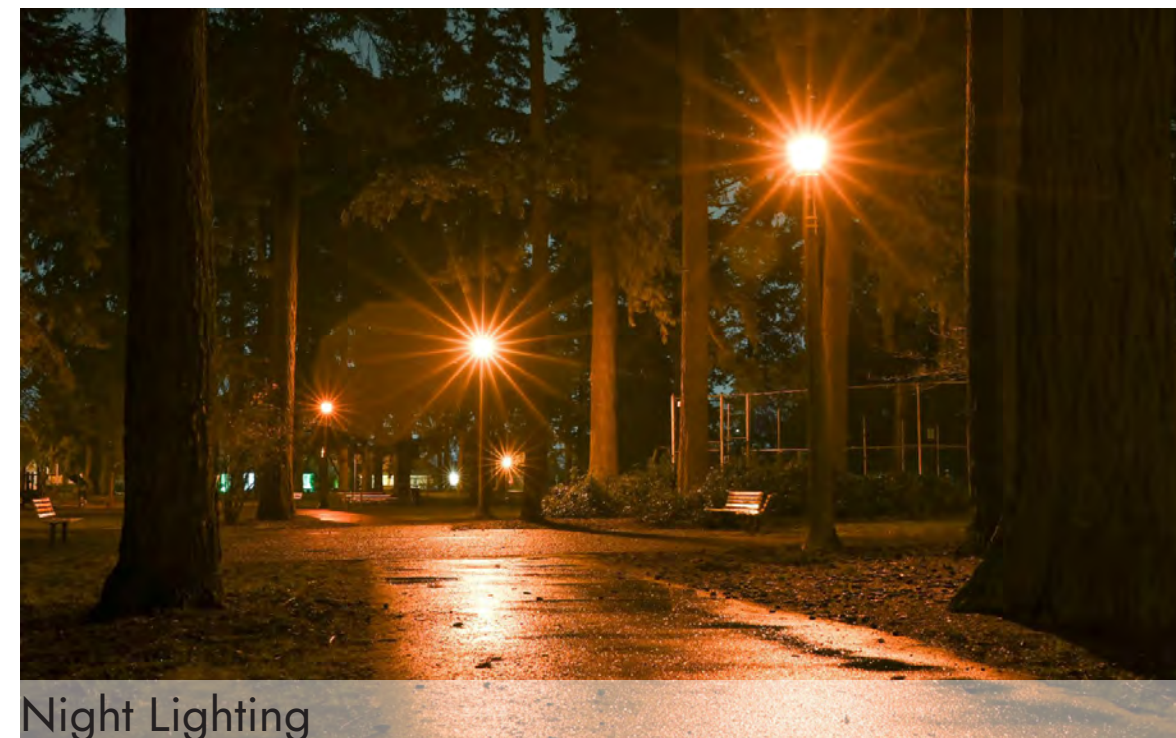

Night Lighting



Benches



Trash Cans

Fill the Gaps

Roosevelt Park already has great assets - basketball courts, tennis courts, a playground, a water fountain, and the Little League field too. But there's lots of room for improvement - residents want a permanent soccer field, reliable skate park amenities, a place to roller skate, a spot to play volleyball, more space for Kids on the Ball, and a public place for kids to cool off during hot summer days.

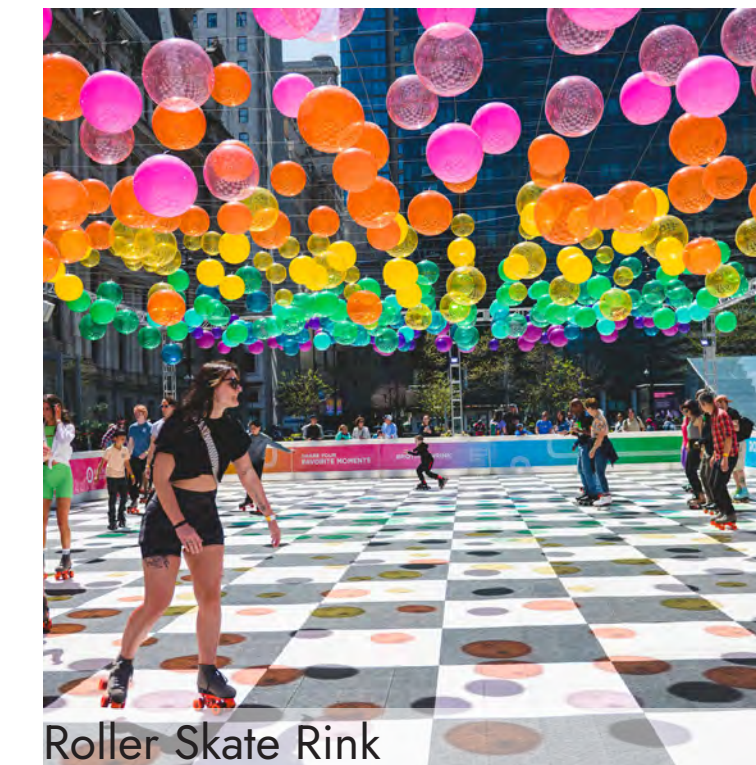

Roller Skate Rink



Flexible Space (Kids on the Ball Expansion Area)



Permanent Soccer Field



Water Play

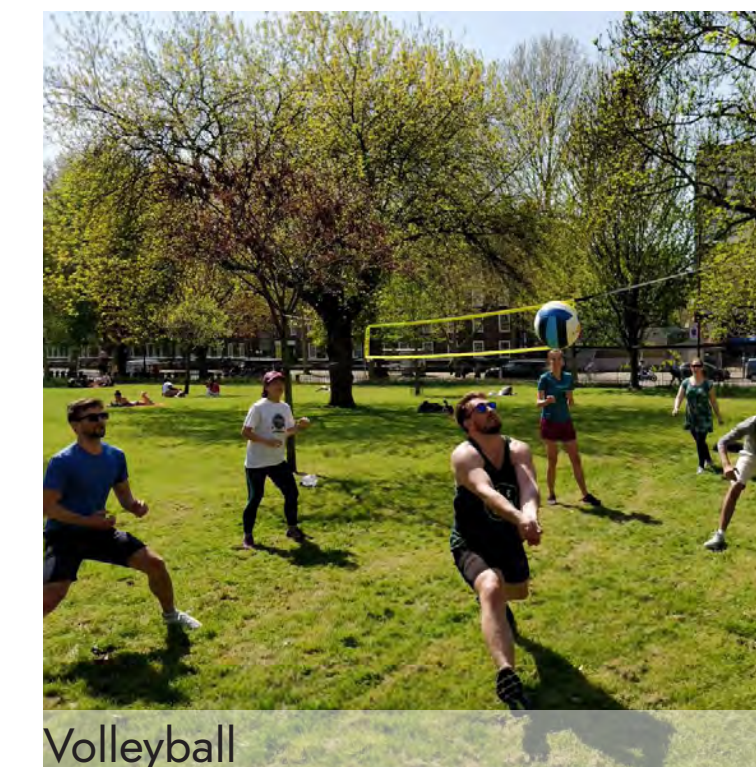

Volleyball

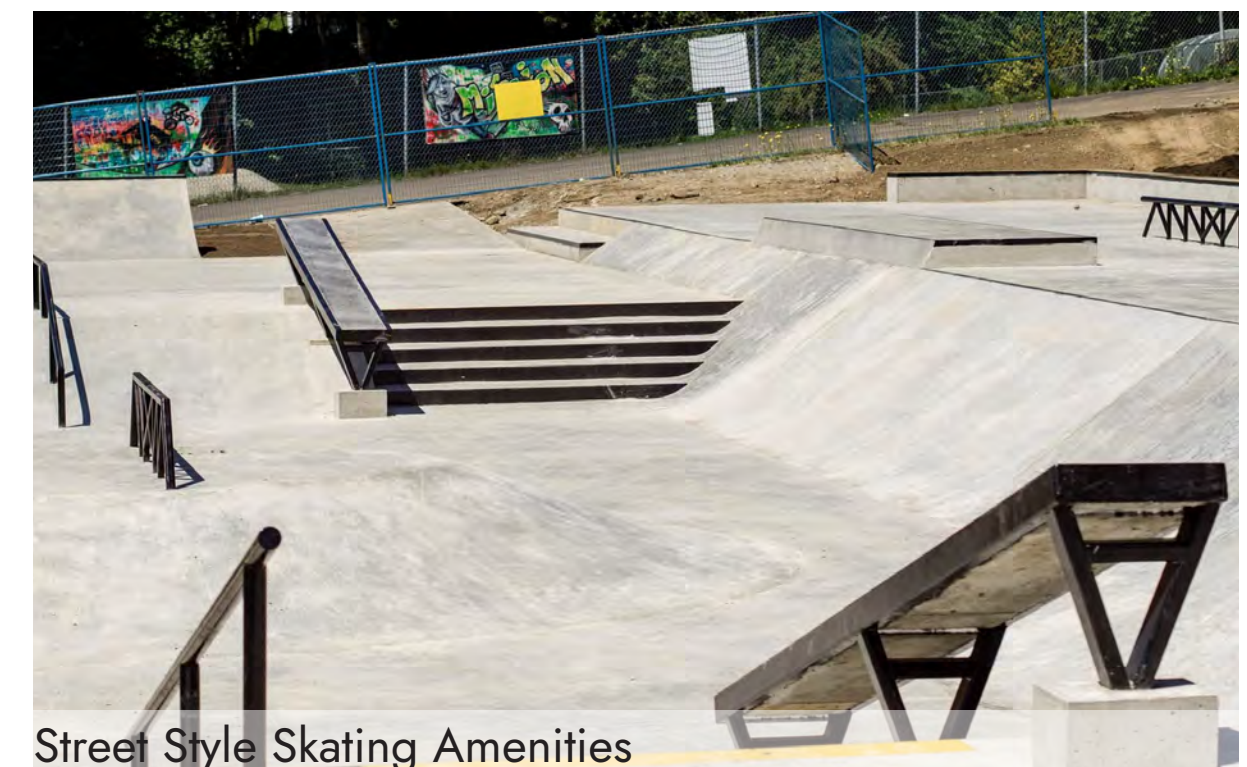

Street Style Skating Amenities

Framework

Oak Street & Willow Street

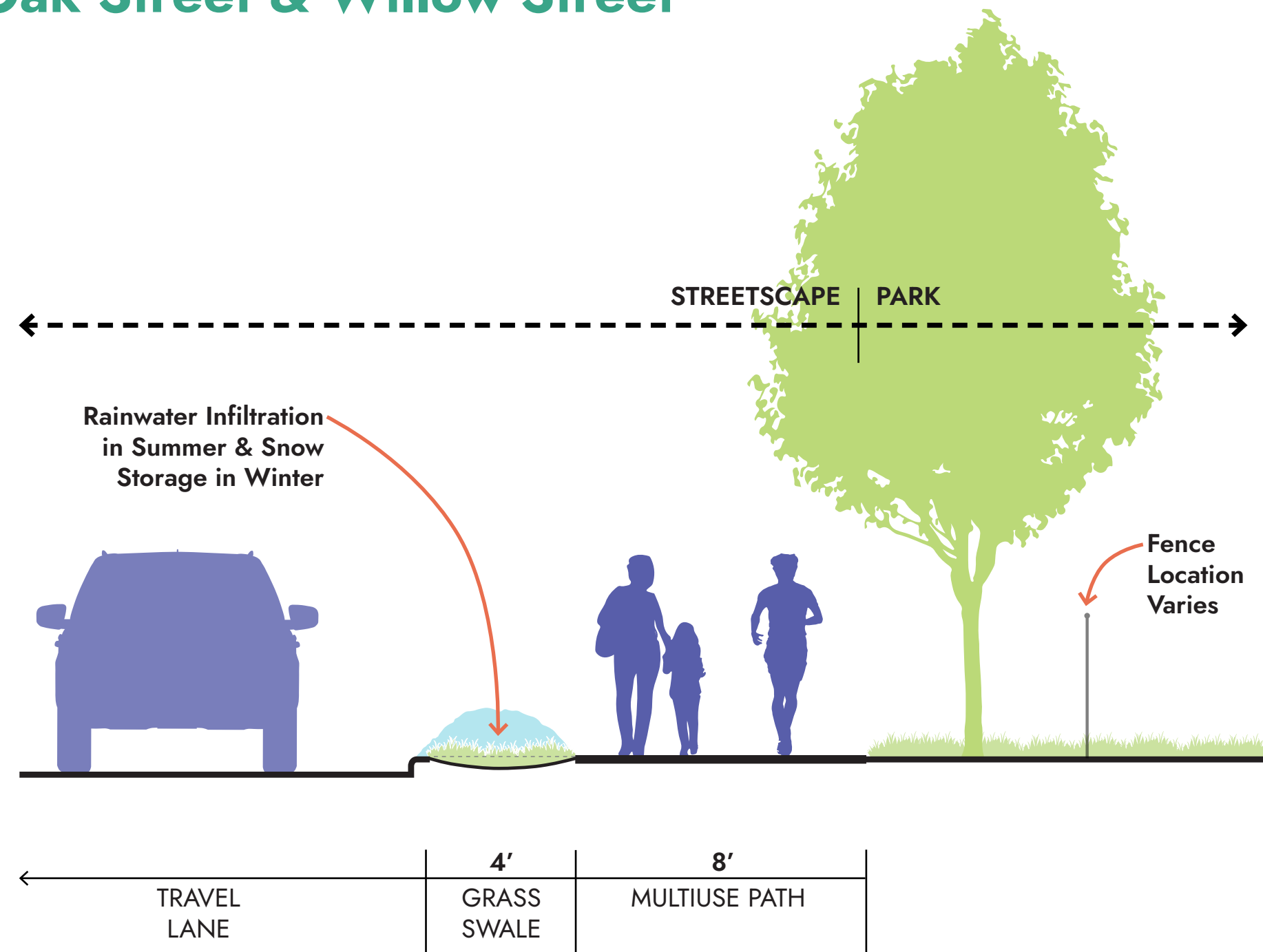

Walnut Street & Saint Mary's Street

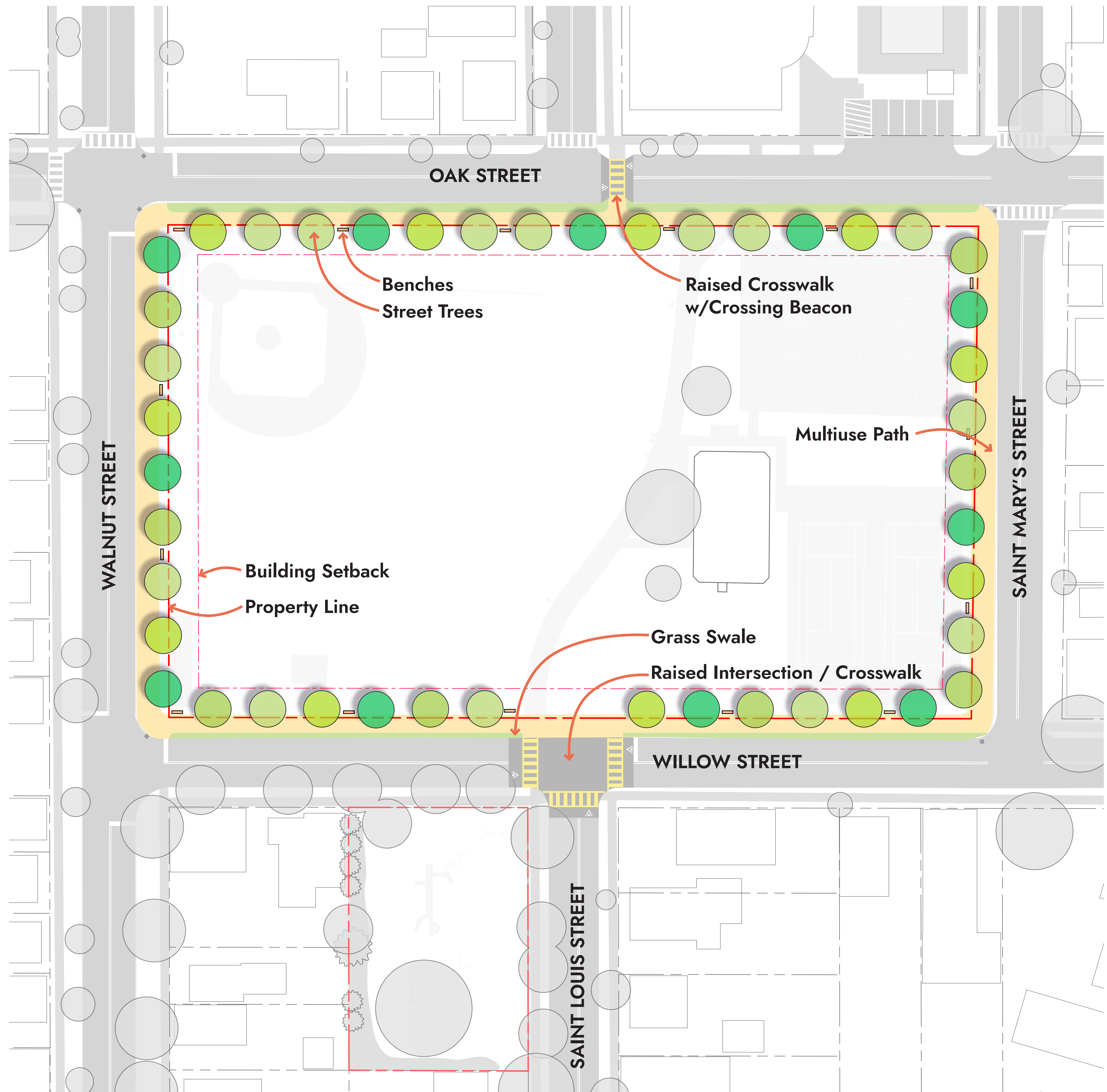
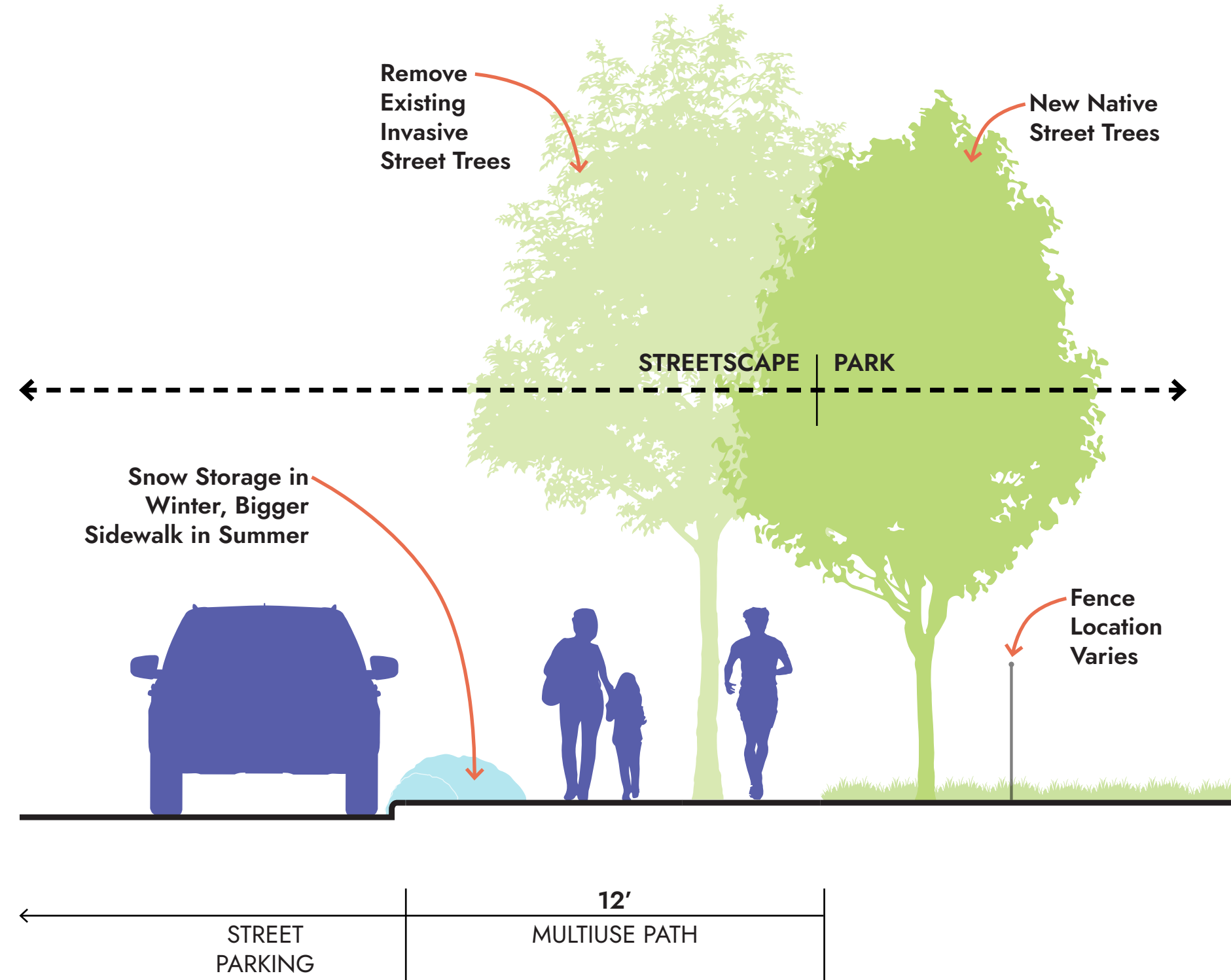

East Side

Key:

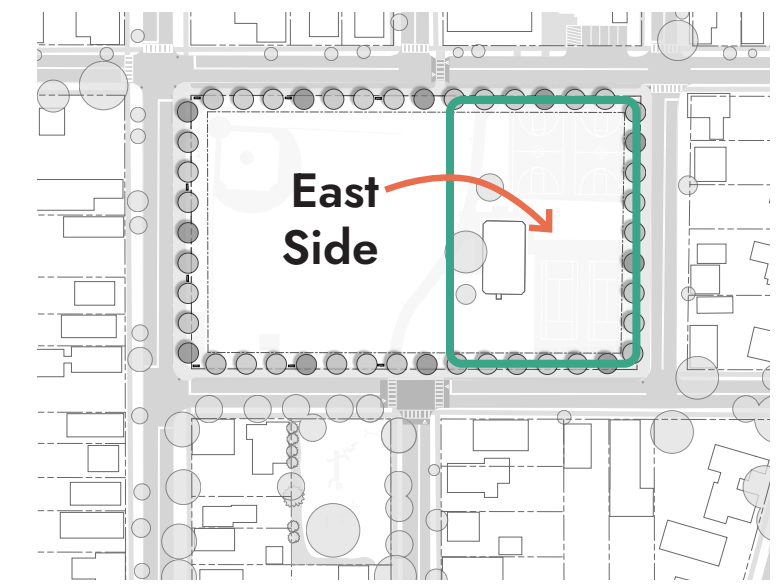

Made In The Shade

Let's add splash pad/fountain, swings + shade (great combo), a skate park, AND handle the stormwater! Pat on the back, please!



Take It To The Court

How about a shade pavilion for parties, more court room for skating + roller disco (+ much more) and throw in a small splash pad too! (why not!)

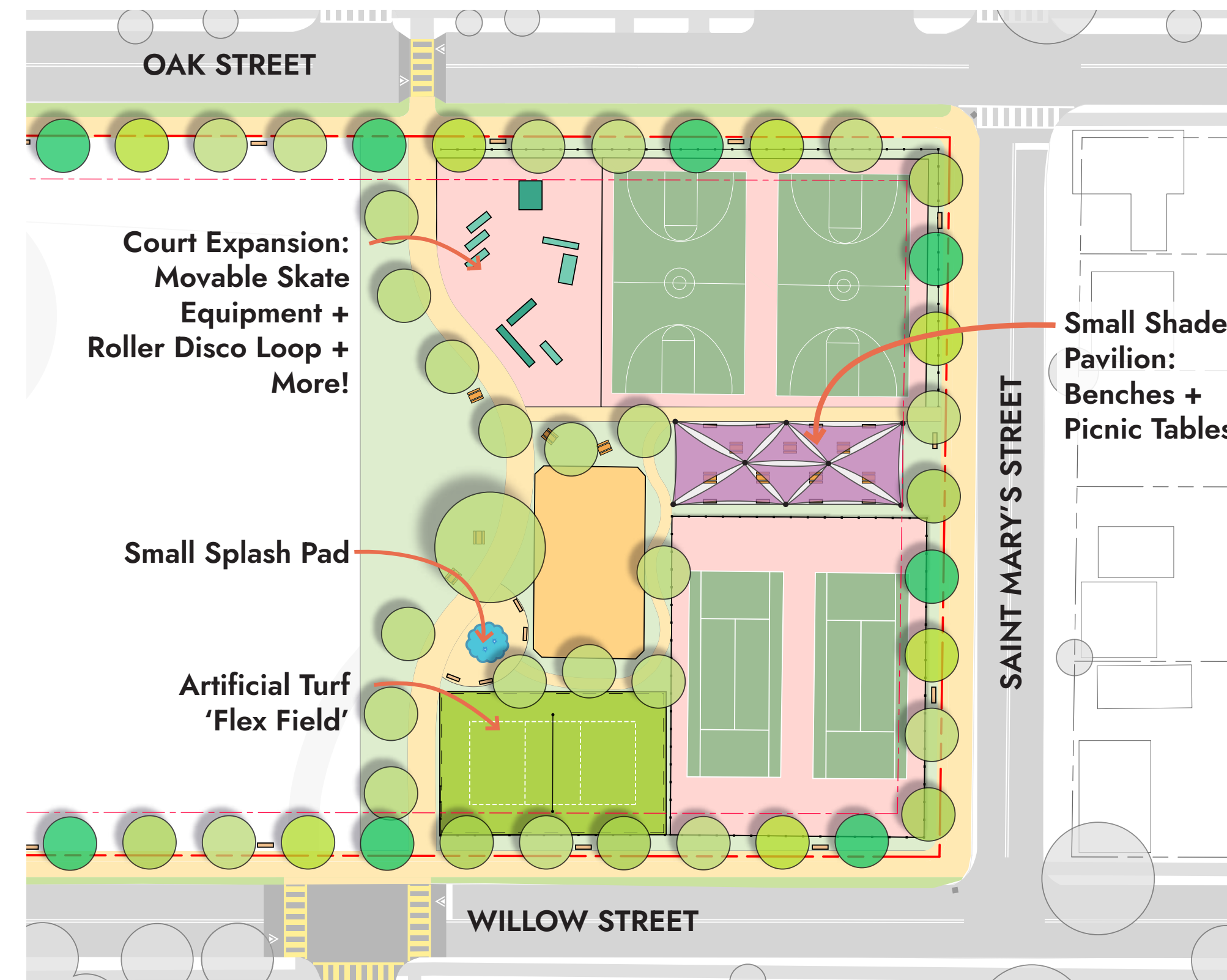

Play It Up!

Go big or go home! BIG splash pad, NEW playground, and LARGE shade pavilion for parties - rain or shine! (Take THAT weather!)

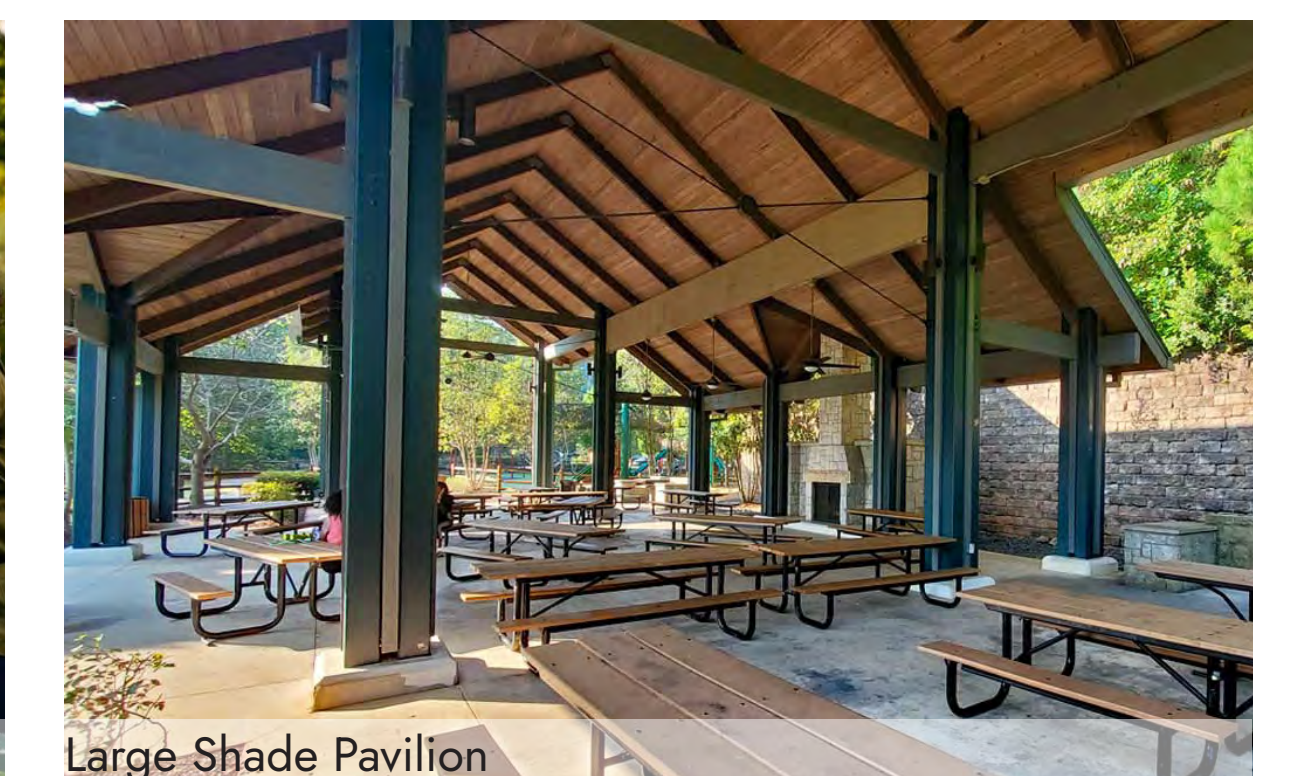
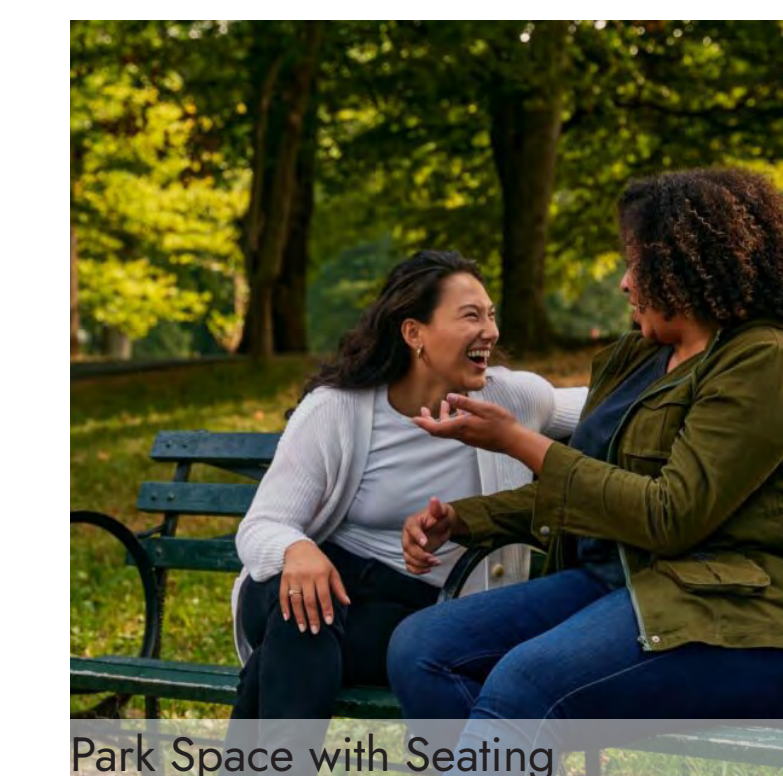
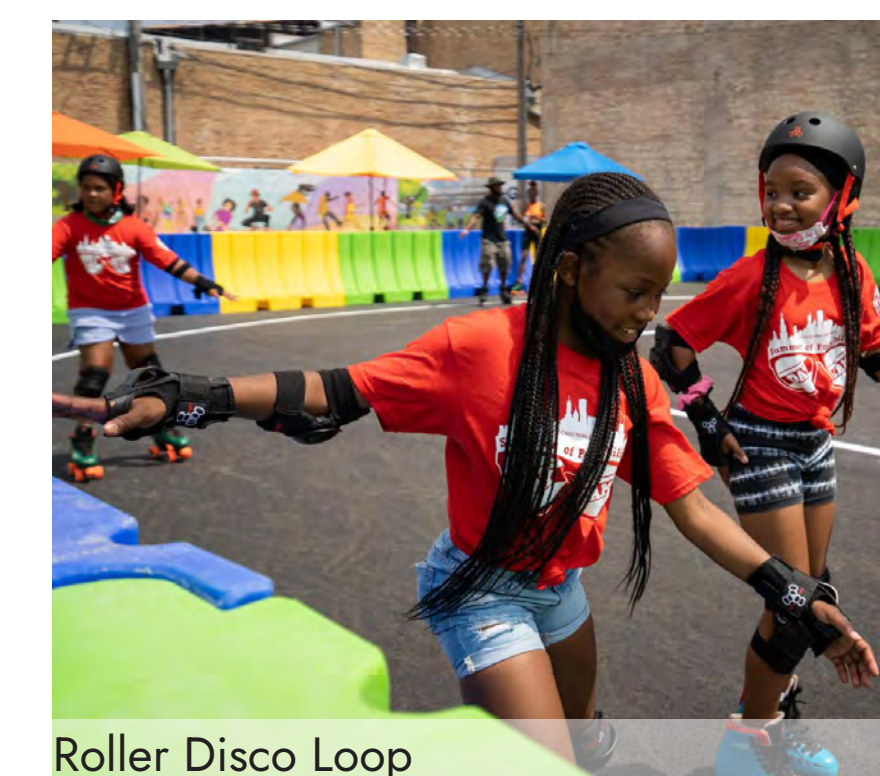
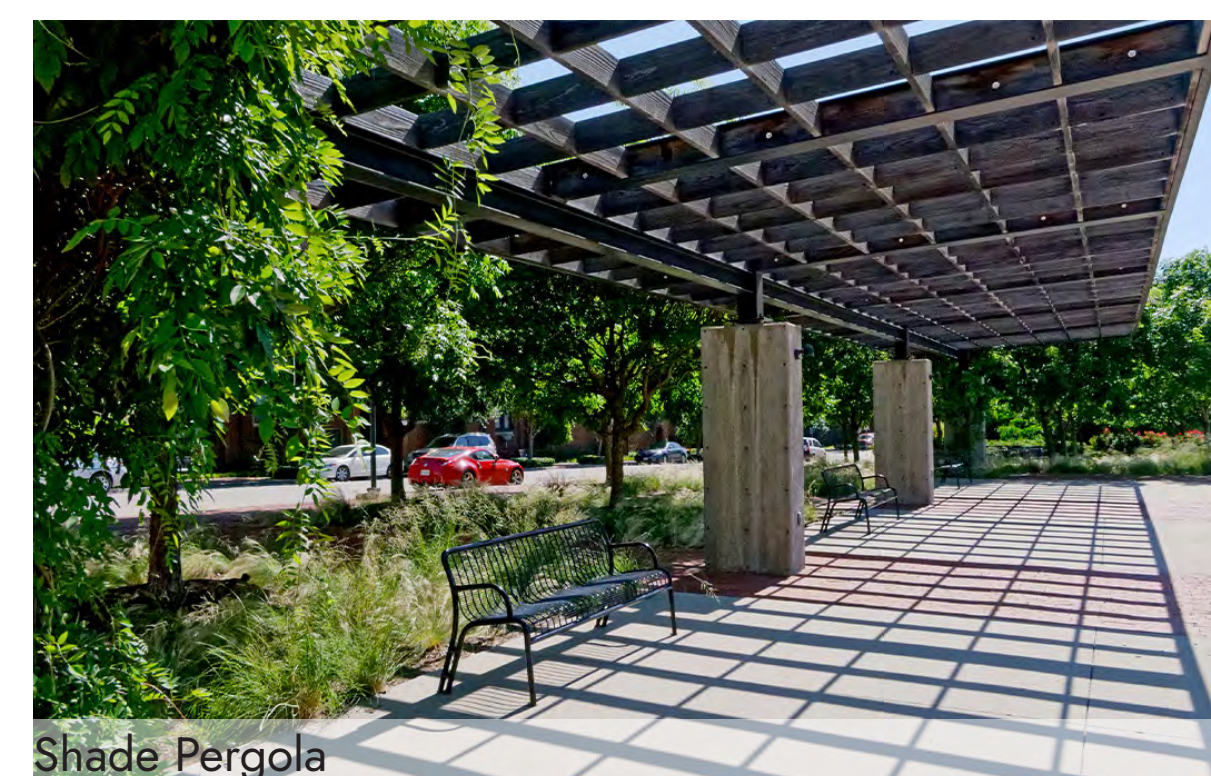
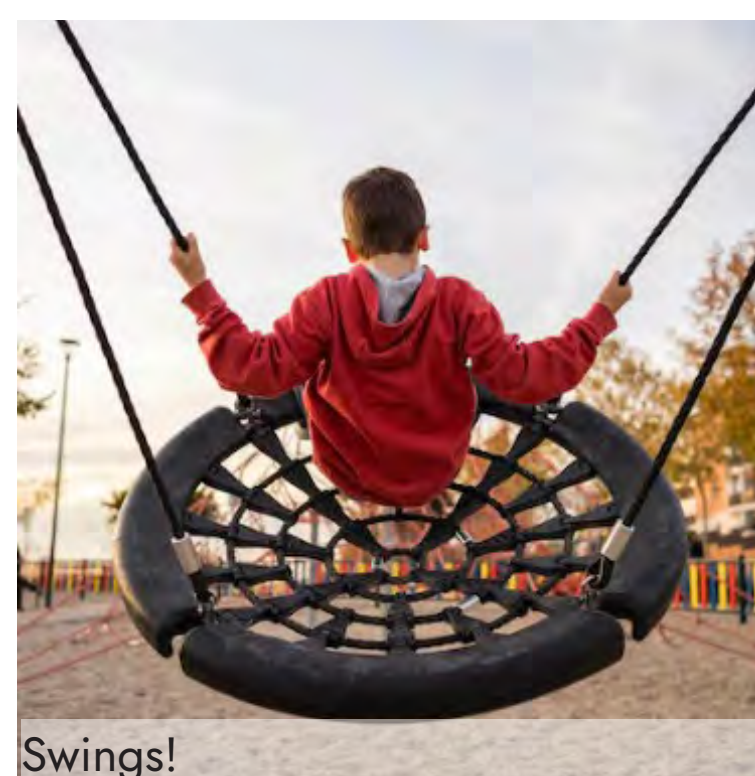
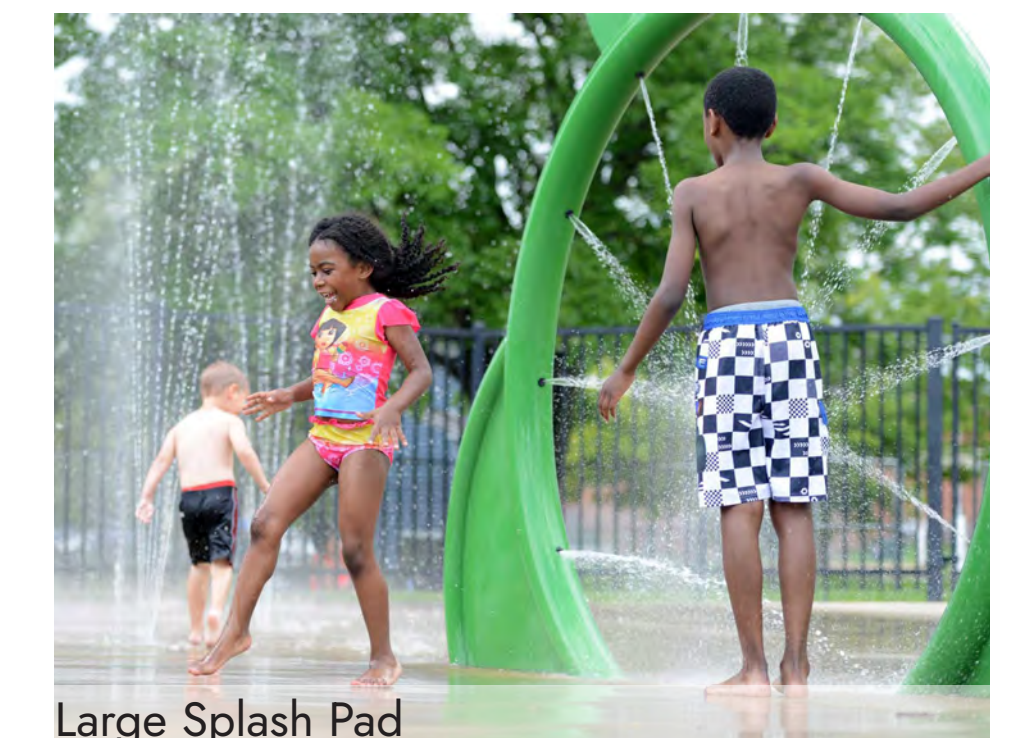
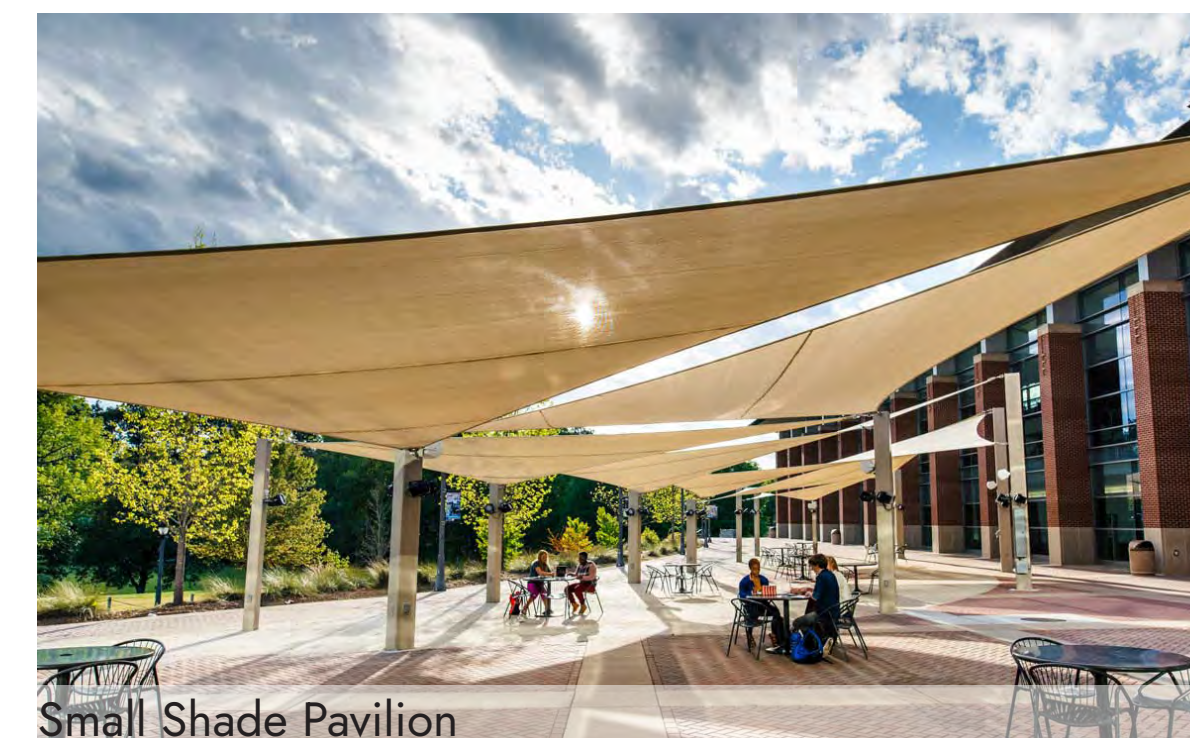
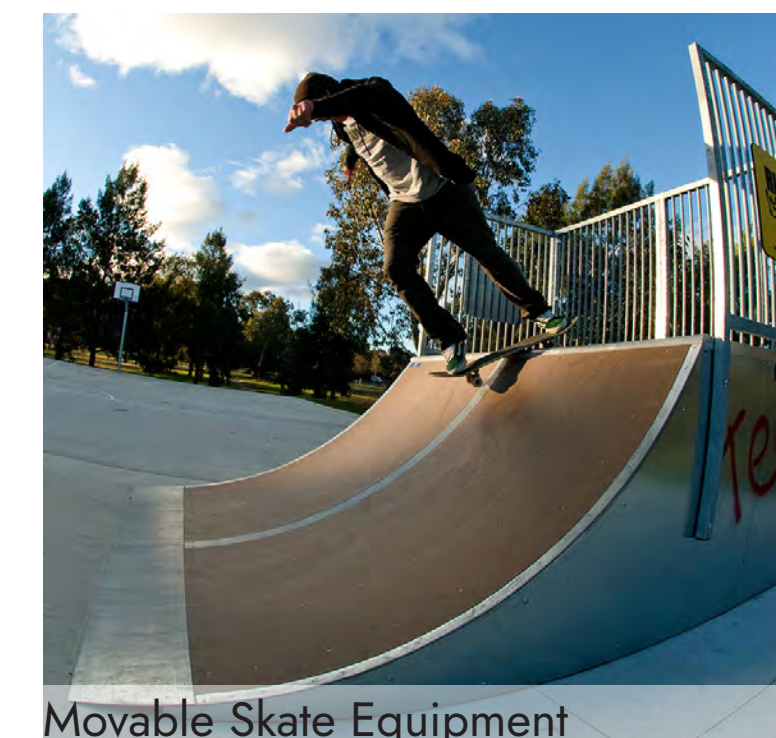
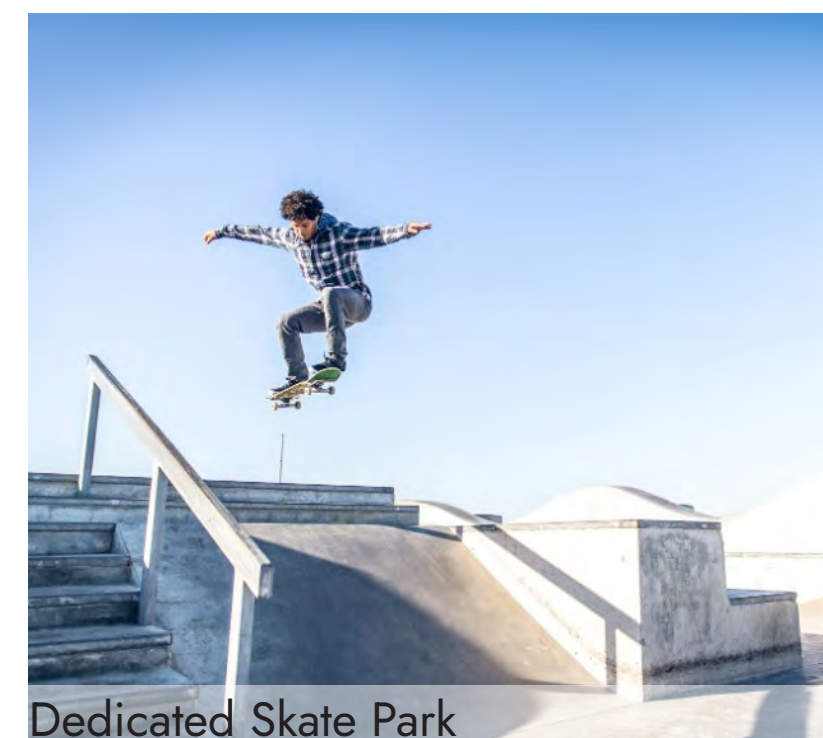

West Side

Key:

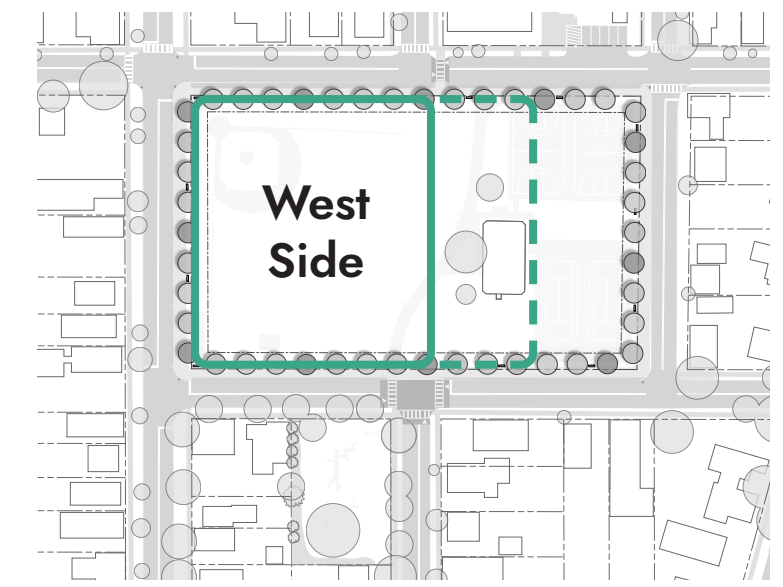

Scooch It In

How about we keep this in bounds - keep what we have, but move it inside the property line. We can squeeze in a soccer field too!



Do The Twist

Did you know that the best orientation for a baseball field is home facing northeast? Let's do it! Plus let's have a soccer field for everyone else!

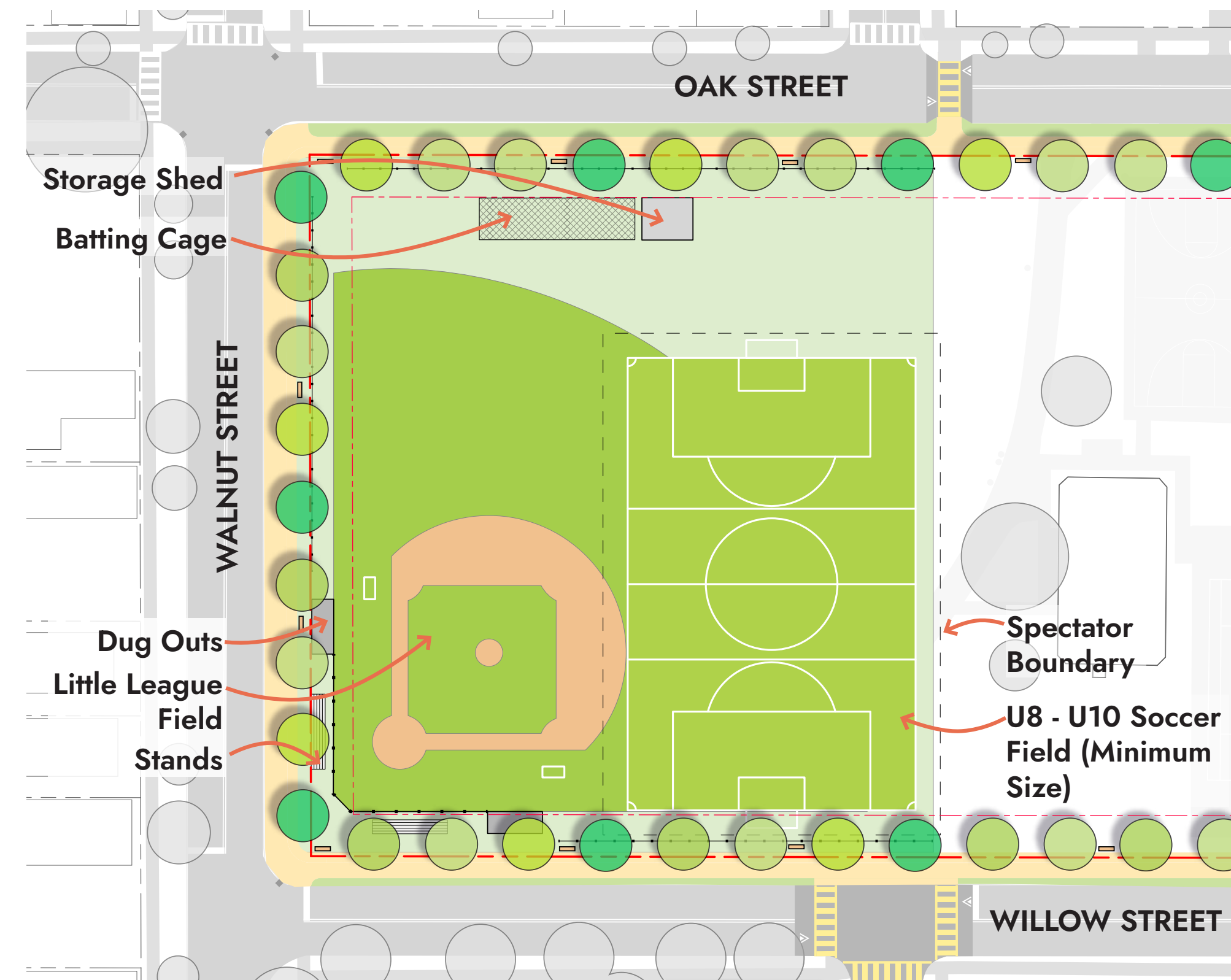

Go BIG or Go Home

What about a full size soccer field with Little League? We can squeeze it in, but we'll need to make some hard decisions for the east side.

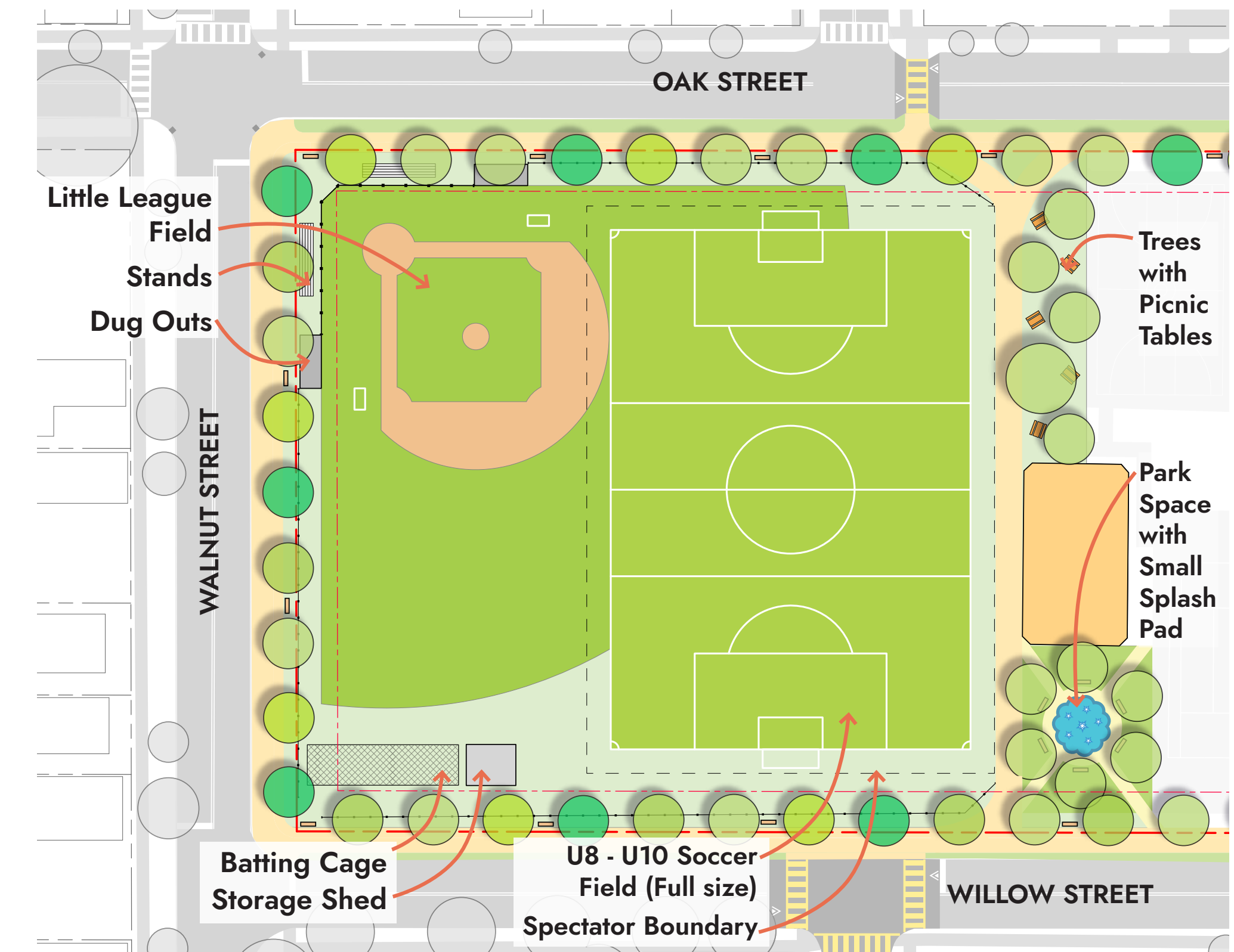

Permanent U8-U10 Soccer Field (Minimum Size)



Shift Existing Batting Cage



New Bleachers

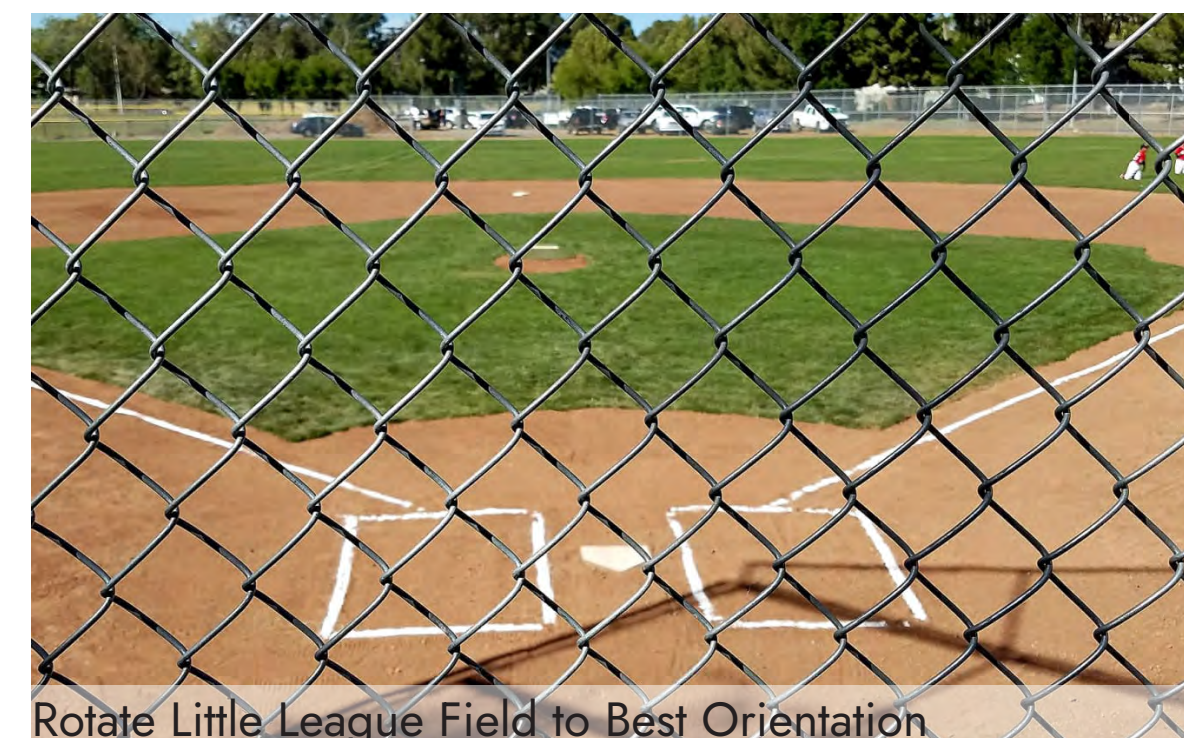

Rotate Little League Field to Best Orientation



Small Splash Pad / Fountain



Room for family + friends to watch the game



Keep Existing Storage Shed



Shift Dugouts



New Storage Shed with Artwork



Permanent Soccer Field (Minimum Size)

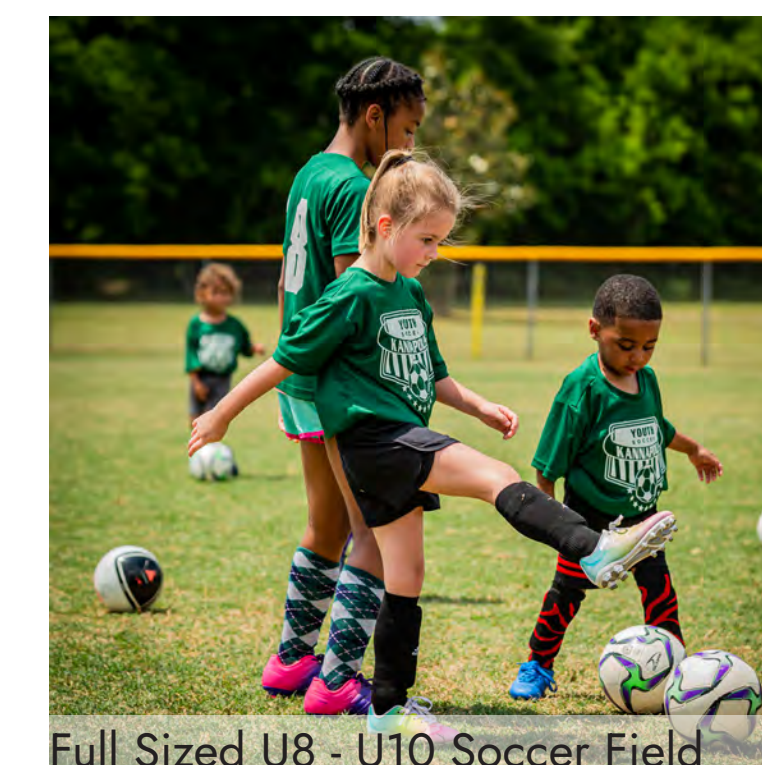

Full Sized U8 - U10 Soccer Field

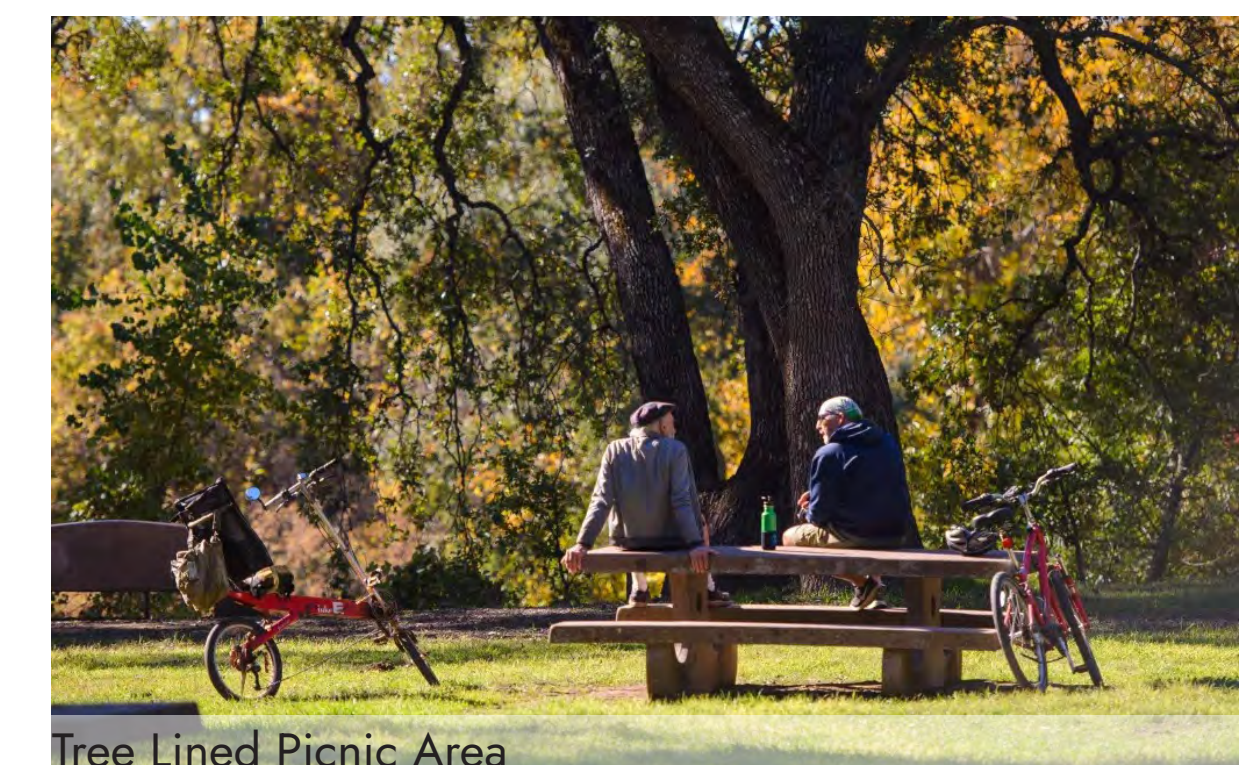

Tree Lined Picnic Area

Lil' Rosie

Key:

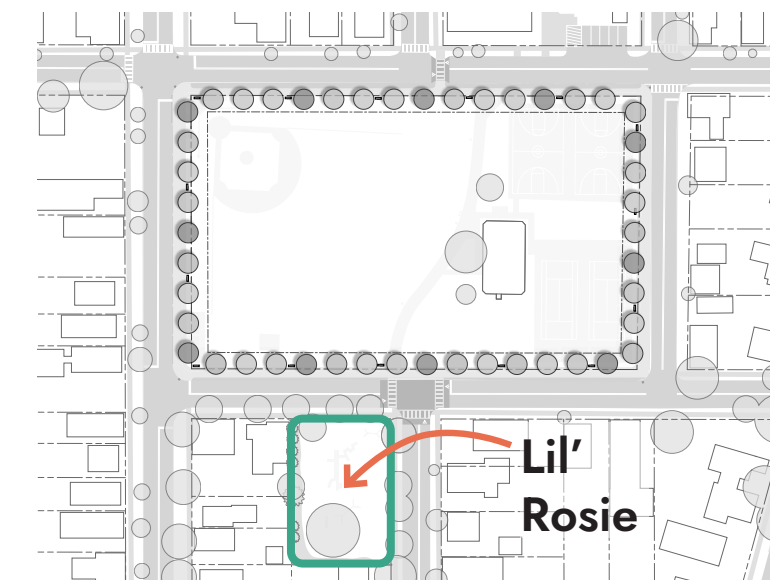

Play Reboot

Let's play it up (round: two)! A new playground with modern equipment and water play to cool off in those hot summer days.

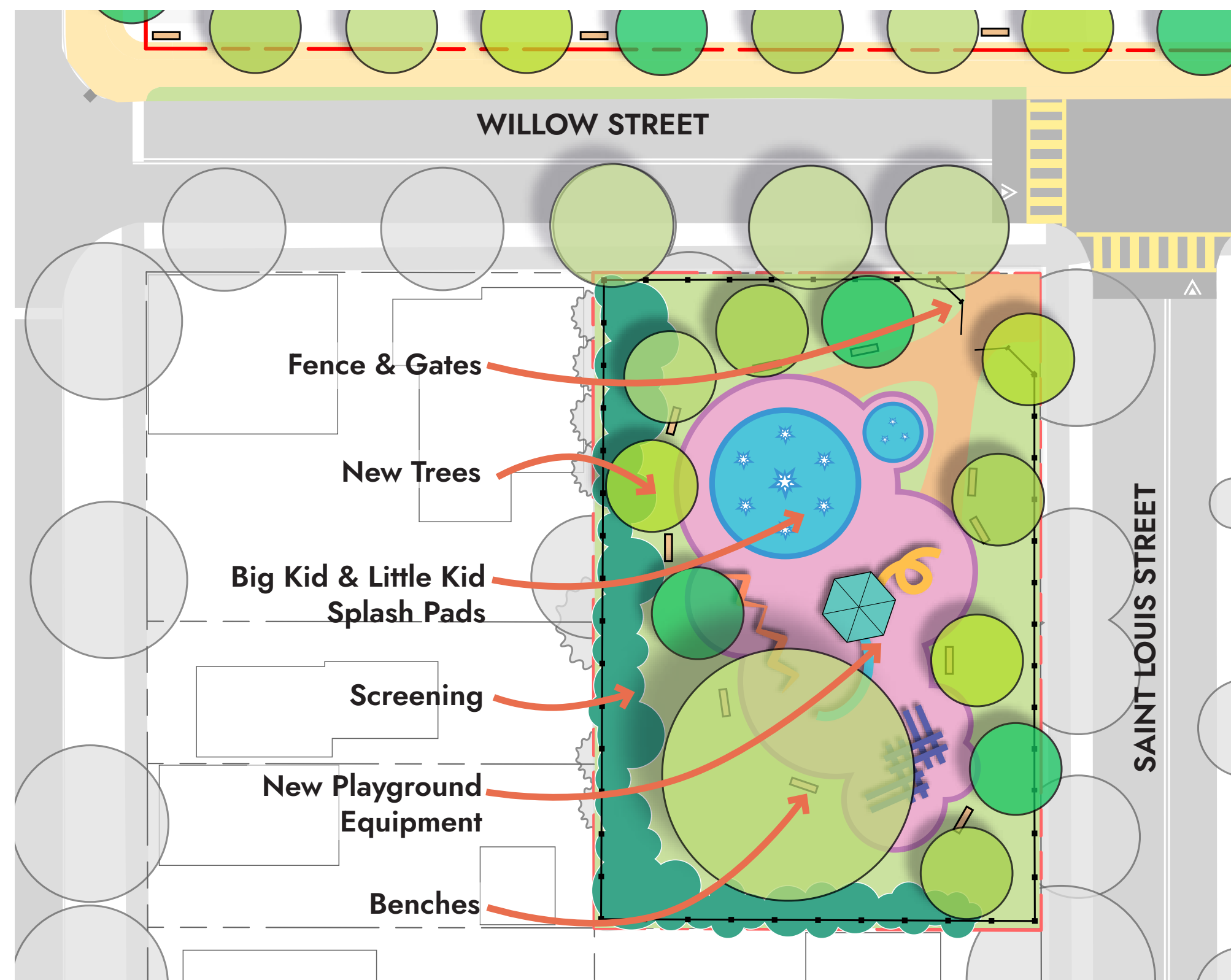

Nature Play

Let's get our hands dirty! How about a natural playground with interactive water play, build your own adventure, and tunnels and slides of course!

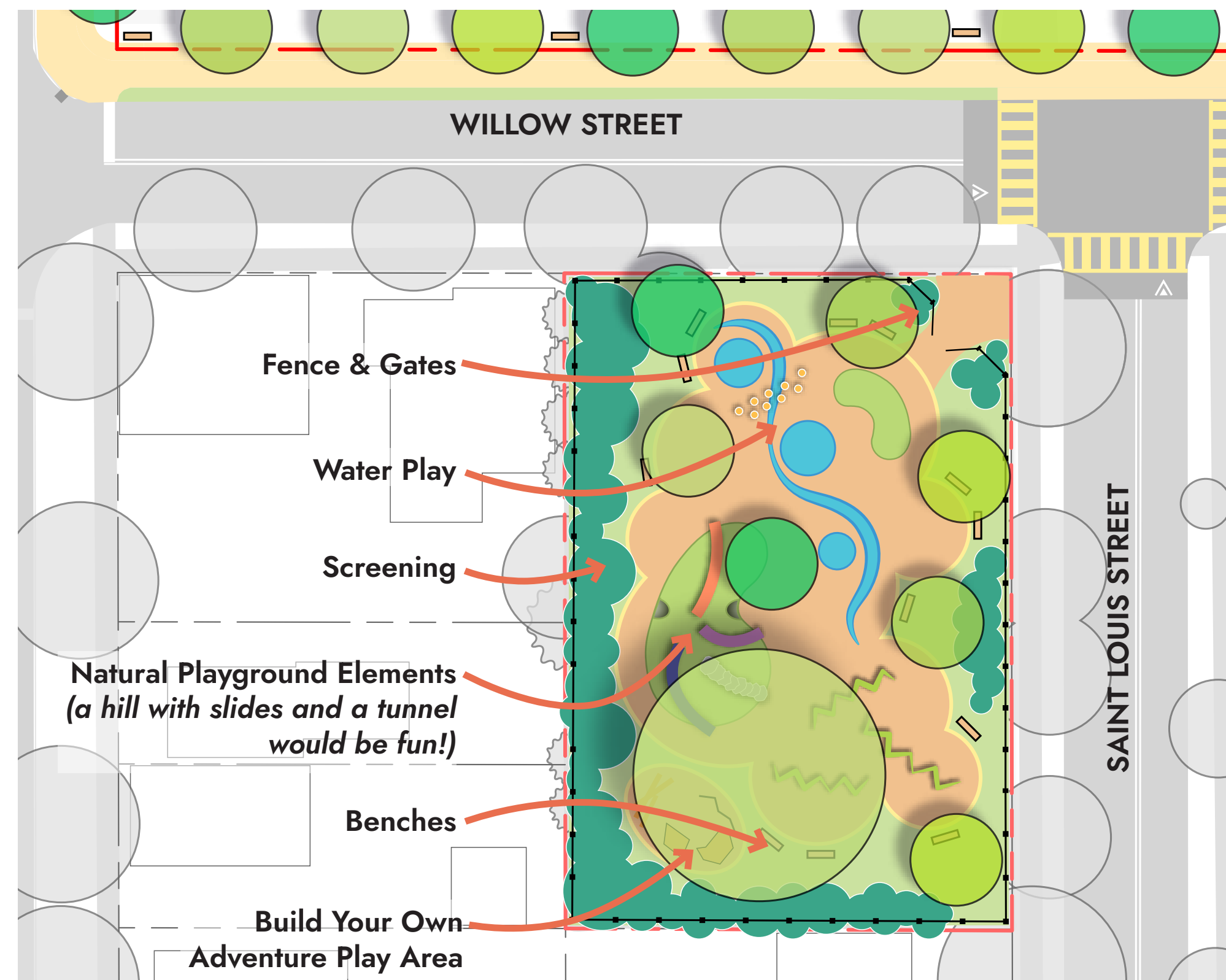

Take it Easy

Let's relax in a nice quiet park space, complete with a splash pad / fountain, an adult/teen fitness station, bench swings, and game tables.

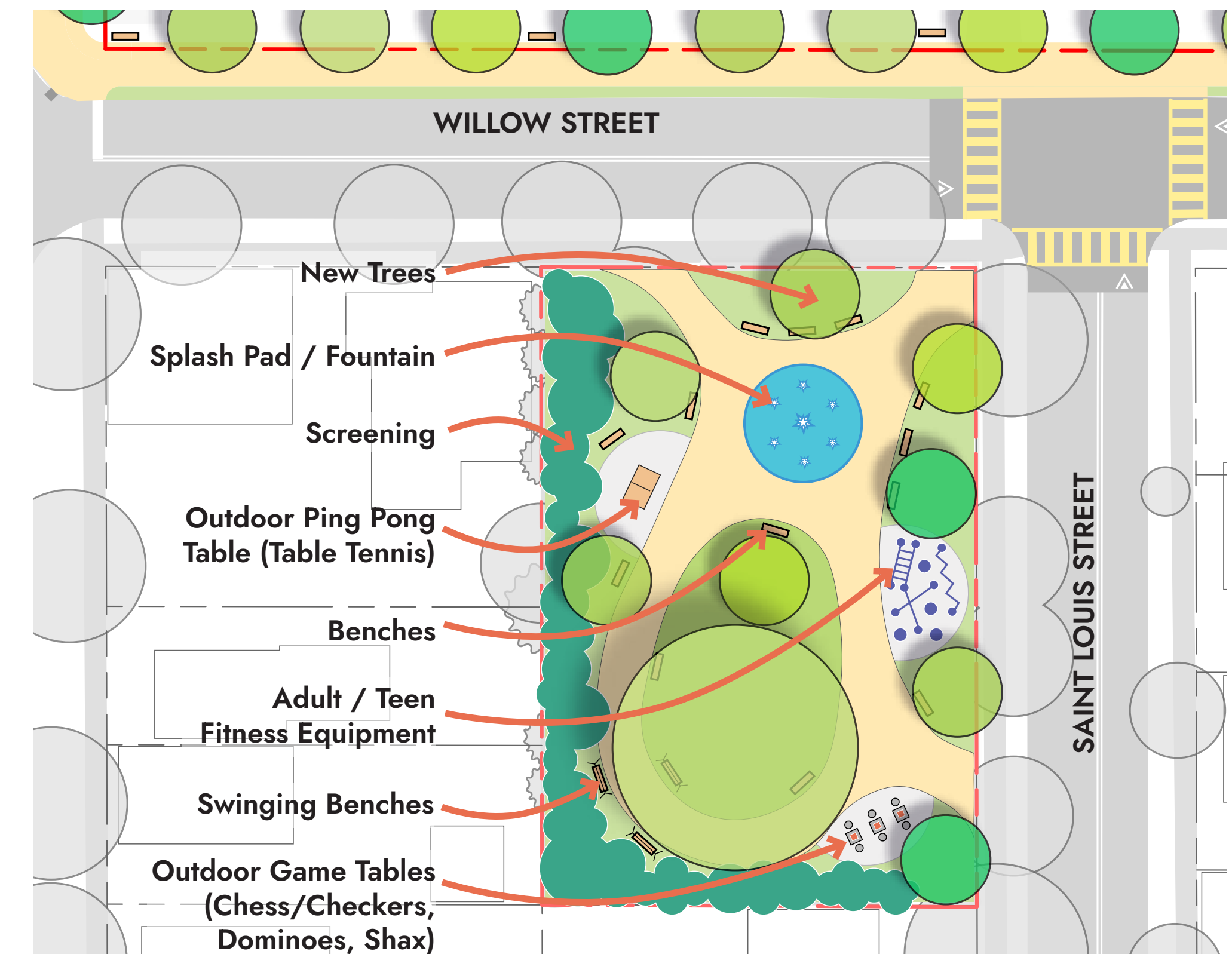

New Standard Playground Equipment



Little Kid Splash Pad



Water Play



Nature Play



Outdoor Ping Pong Table



Adult / Teen Fitness Equipment

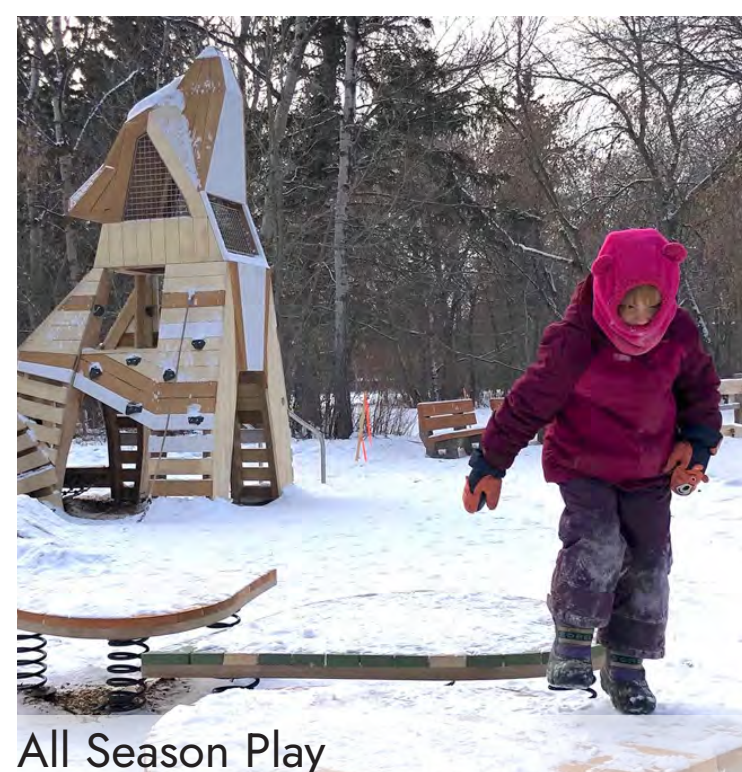

All Season Play

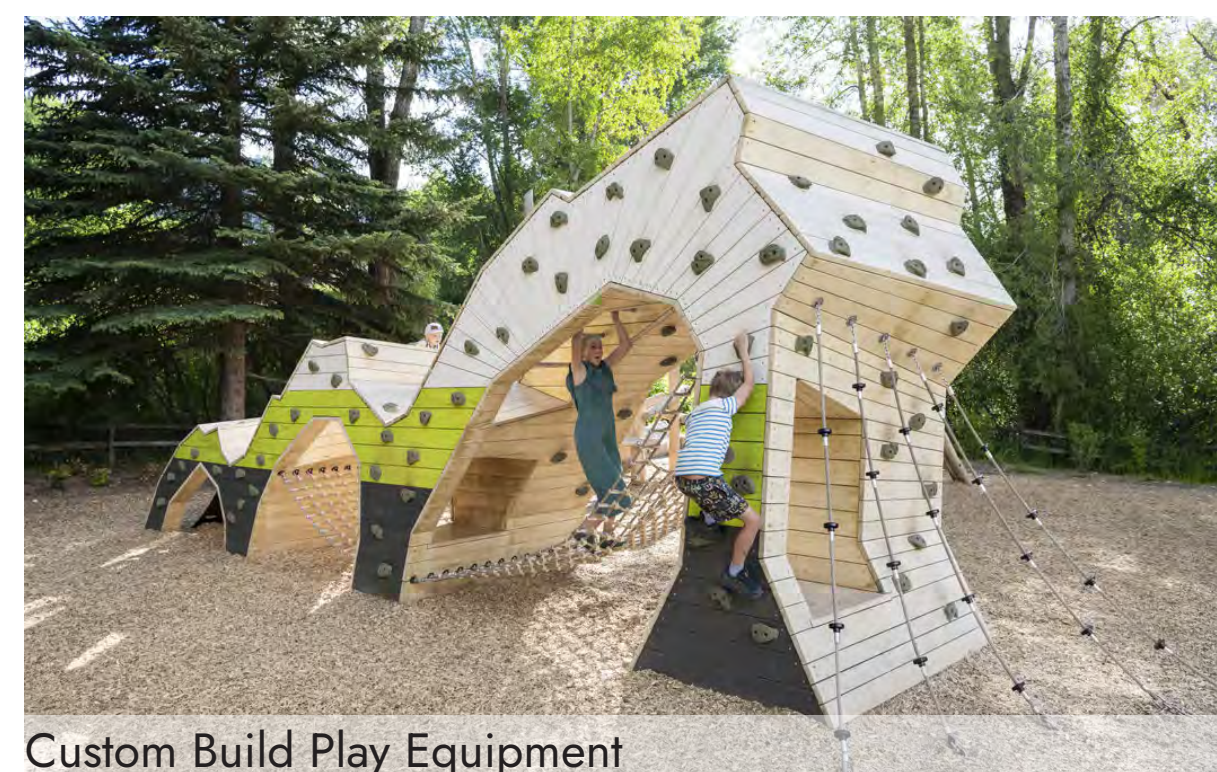

Custom Build Play Equipment



Nature Play: Slides & Tunnels



Build Your Own Adventure Play

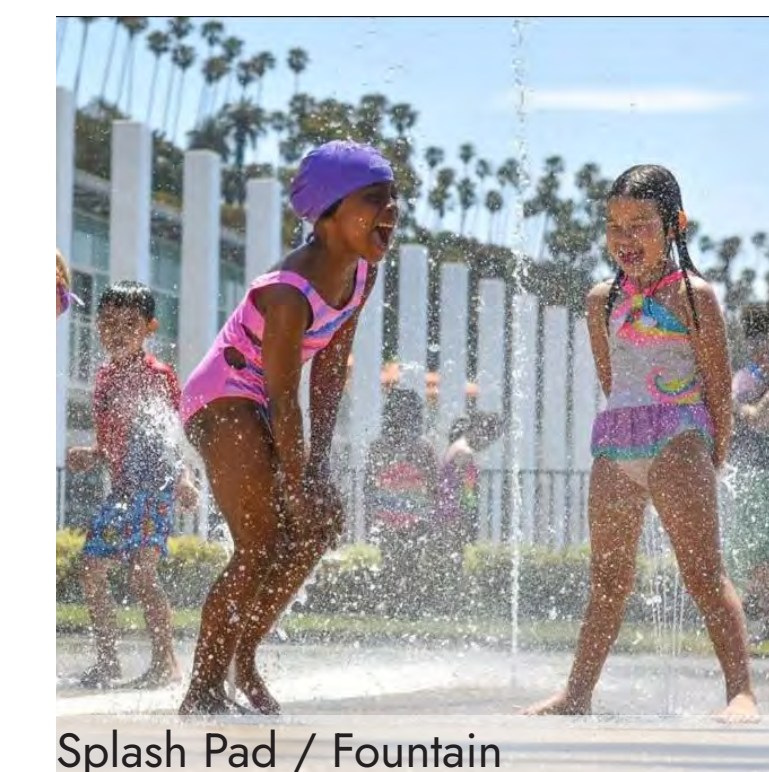

Splash Pad / Fountain



Swinging Benches